

Appendix B

PLAN OF LANDHOLDING

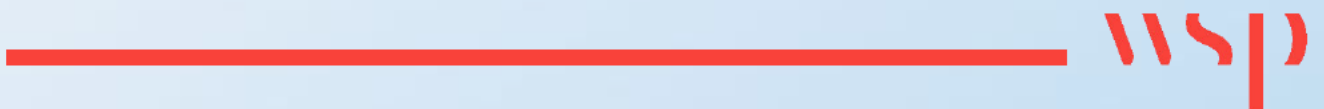

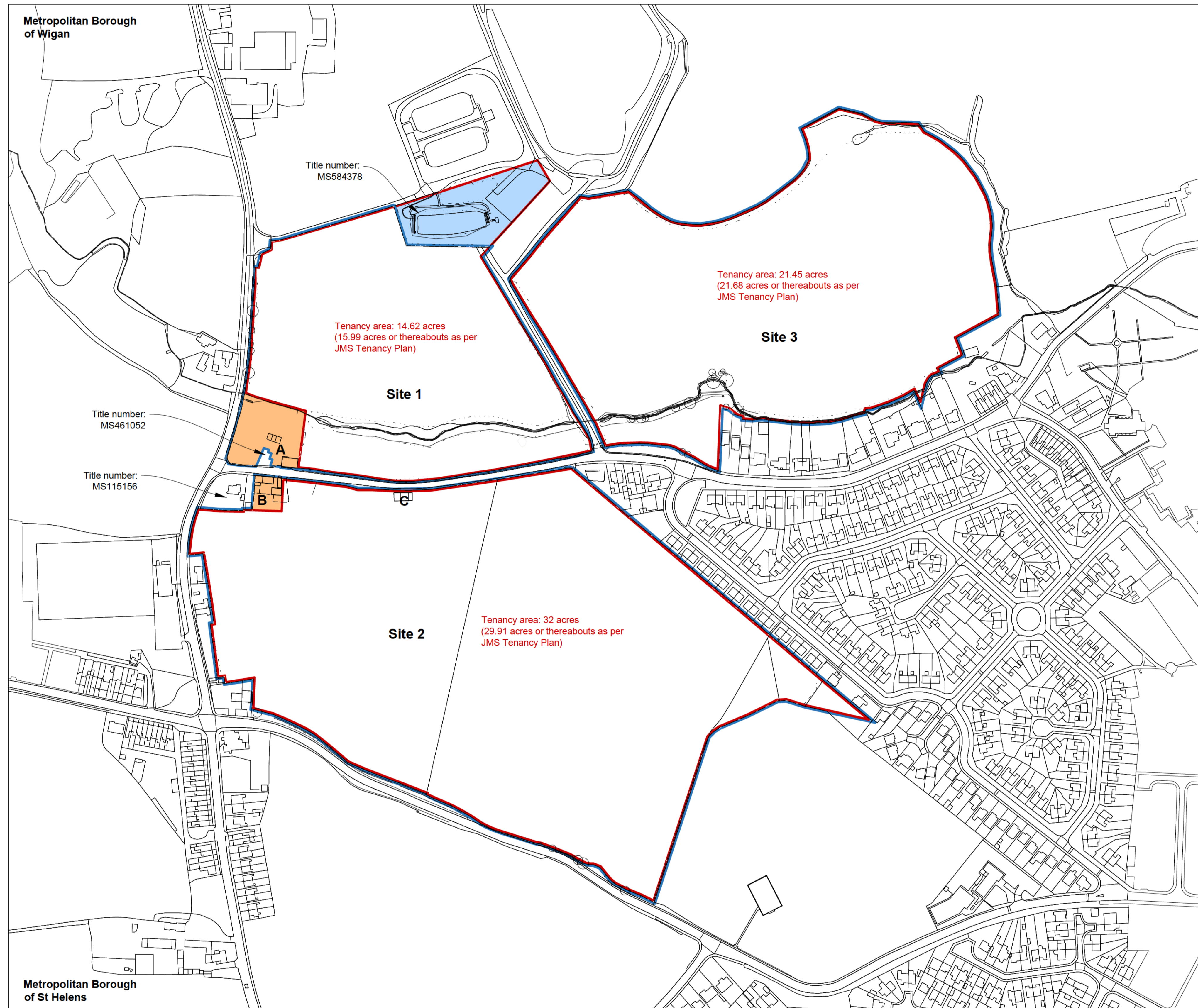

SITE

- JMS ownership boundary line
HM Land Registry: refer to landscape registry title number MS486918
- Tenancy line as per JMS Tenancy Plan (Wigan Road, Warrington WA3 3UB)
- - - Borough Boundary Line
- Area outside ownership boundary and inside tenancy line
- Area inside ownership boundary and outside tenancy line
- A, B, C** Existing barns and farmhouses within JMS ownership

01 TENANCY / OWNERSHIP REVIEW
113_1004 1:2000@A1

NOTES:

Drawing based on Murphy survey drawings LBU0159_Leyland Green Farm_1-4 rev 4 dated 08.03.2019.
The information relating to the tenancy line is based on information provided by Murphy Group.
The location of any services or constraints is also subject to a detailed site survey.

KEY PLAN:

Outside
Centre line is line of boundary/demise/tenancy
Inside

REVISIONS

Rev.	Description	Date	Checked
-	Draft Issue	11.06.19	

Richard Hopkinson Architects

220 Vale Road
Tonbridge
Kent TN9 1SP
rhopkinson@hopkinsonarchitects.com
www.richardhopkinsonarchitects.com

PROJECT TITLE
LEYLAND GREEN FARM

DRAWING TITLE
TENANCY / OWNERSHIP REVIEW

PROJECT NO	DRAWING NO	REVISION NO	STATUS	SCALE
113	1004	-	DRAFT	1:2000@A1

DRAWN DATE: 06.19 CHECKED BY: DOD This drawing is © copyright by Richard Hopkinson Architects Ltd

