

# Appendix B

## PLAN OF LANDHOLDING

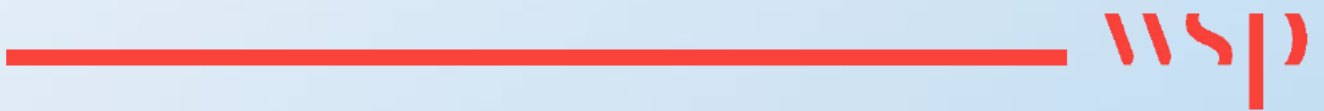

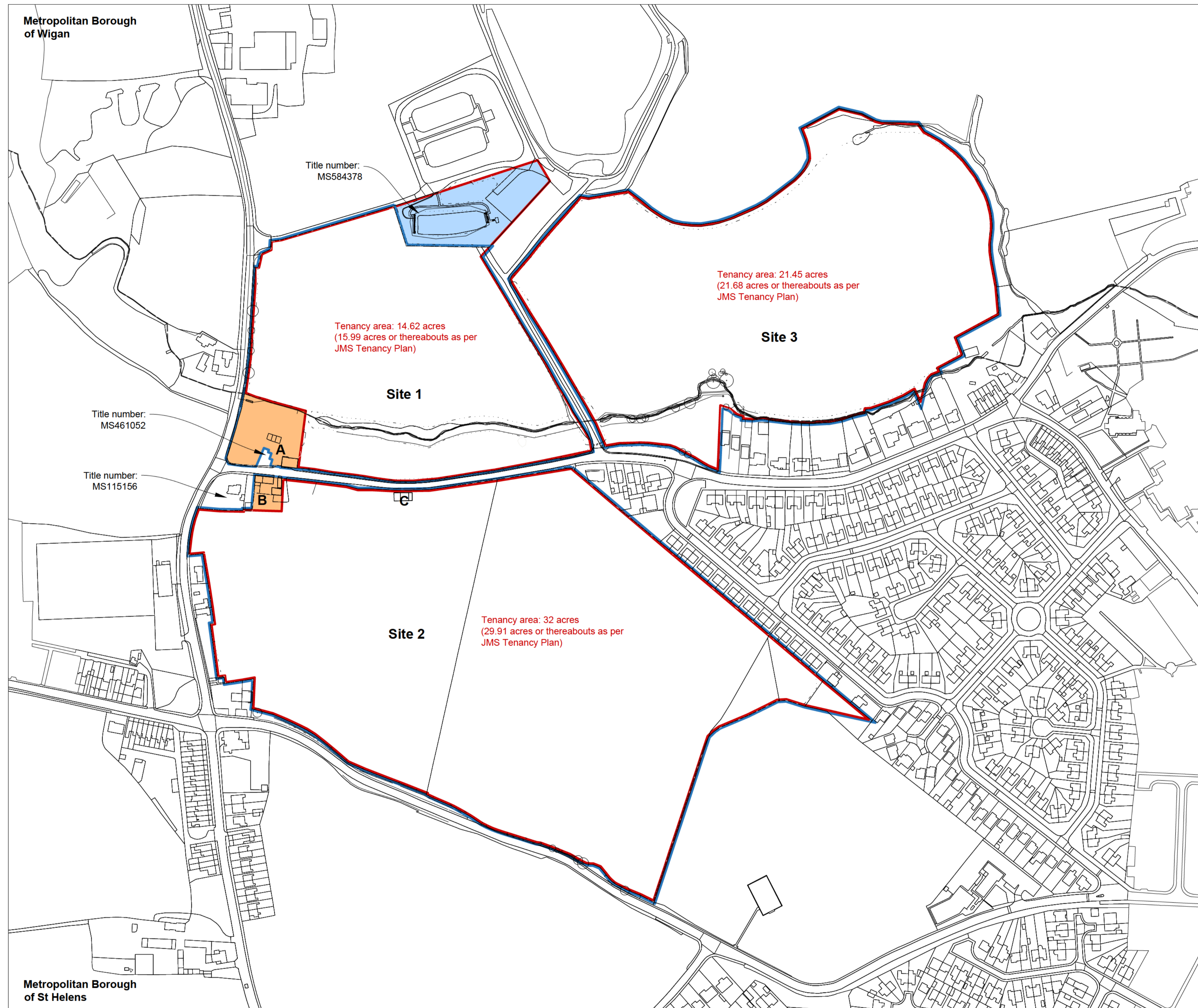

**SITE**

- JMS ownership boundary line  
HM Land Registry: refer to landscape registry title number MS486918
- Tenancy line as per JMS Tenancy Plan (Wigan Road, Warrington WA3 3UB)
- - - Borough Boundary Line
- Area outside ownership boundary and inside tenancy line
- Area inside ownership boundary and outside tenancy line
- A, B, C** Existing barns and farmhouses within JMS ownership

**01** TENANCY / OWNERSHIP REVIEW  
113\_1004 1:2000@A1

**NOTES:**

Drawing based on Murphy survey drawings LBU0159\_Leyland Green Farm\_1-4 rev 4 dated 08.03.2019.  
The information relating to the tenancy line is based on information provided by Murphy Group.  
The location of any services or constraints is also subject to a detailed site survey.

**KEY PLAN:**

Outside  
Centre line is line of boundary/demise/tenancy  
Inside

**REVISIONS**

Rev.	Description	Date	Checked
-	Draft Issue	11.06.19	

Richard Hopkinson Architects

220 Vale Road  
Tonbridge  
Kent TN9 1SP

[rh@richardhopkinsonarchitects.com](mailto:rh@richardhopkinsonarchitects.com)  
[www.richardhopkinsonarchitects.com](http://www.richardhopkinsonarchitects.com)

PROJECT TITLE  
**LEYLAND GREEN FARM**

DRAWING TITLE  
**TENANCY / OWNERSHIP REVIEW**

PROJECT NO	DRAWING NO	REVISION NO	STATUS	SCALE
113	1004	-	DRAFT	1:2000@A1

DRAWN DATE: 06.19  
CHECKED BY: DOD  
This drawing is © copyright by Richard Hopkinson Architects Ltd

