

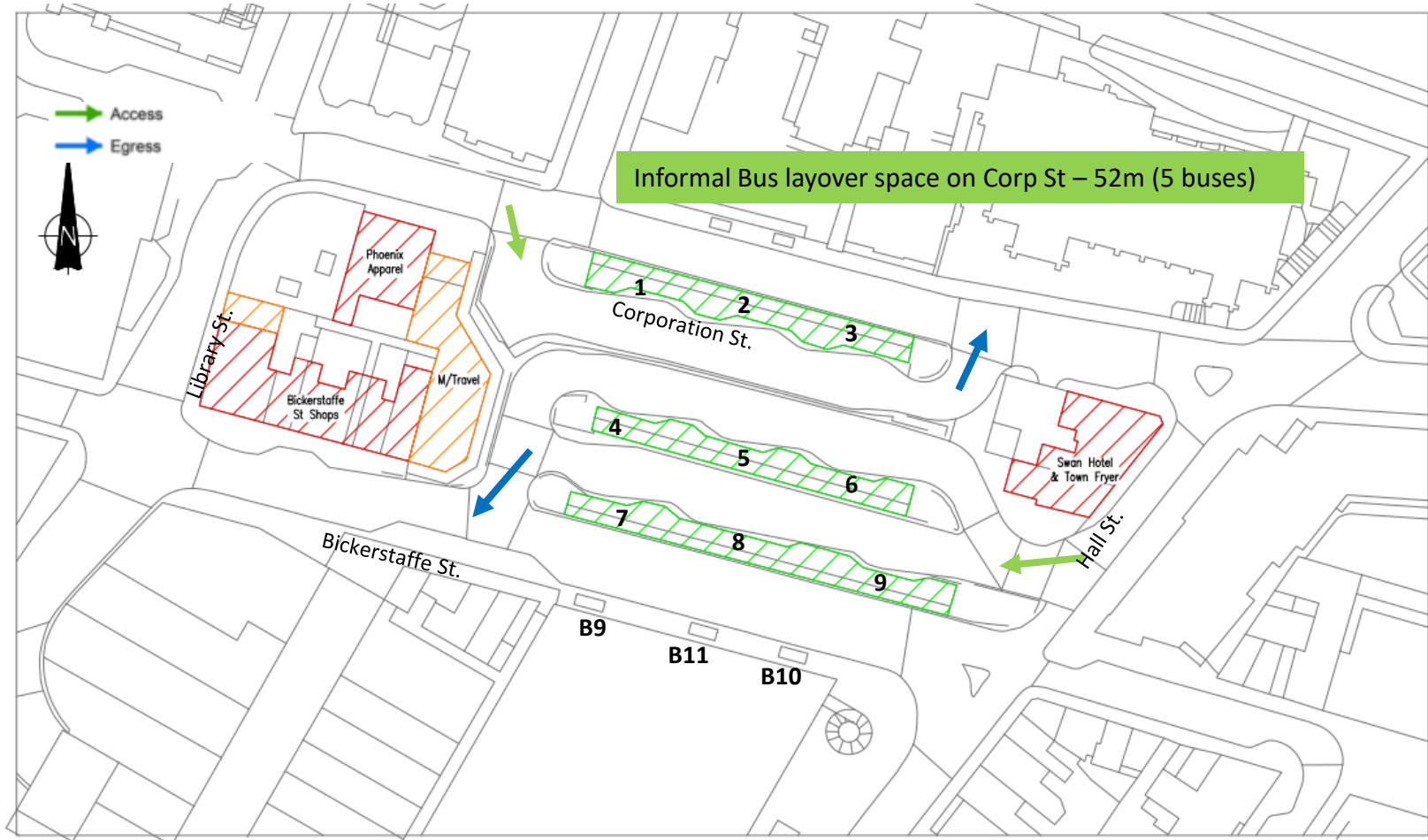

# St Helens Town Centre Multi-Modal Interchange

Options Technical Report – Appendix A

# Existing Bus Station Layout



Source: LCRCA drawing prepared by Waterman

# Buses by Direction and Entry Point

118 x 2 way buses per hour

54 x 2 way buses per hour

8 x 2 way buses per hour

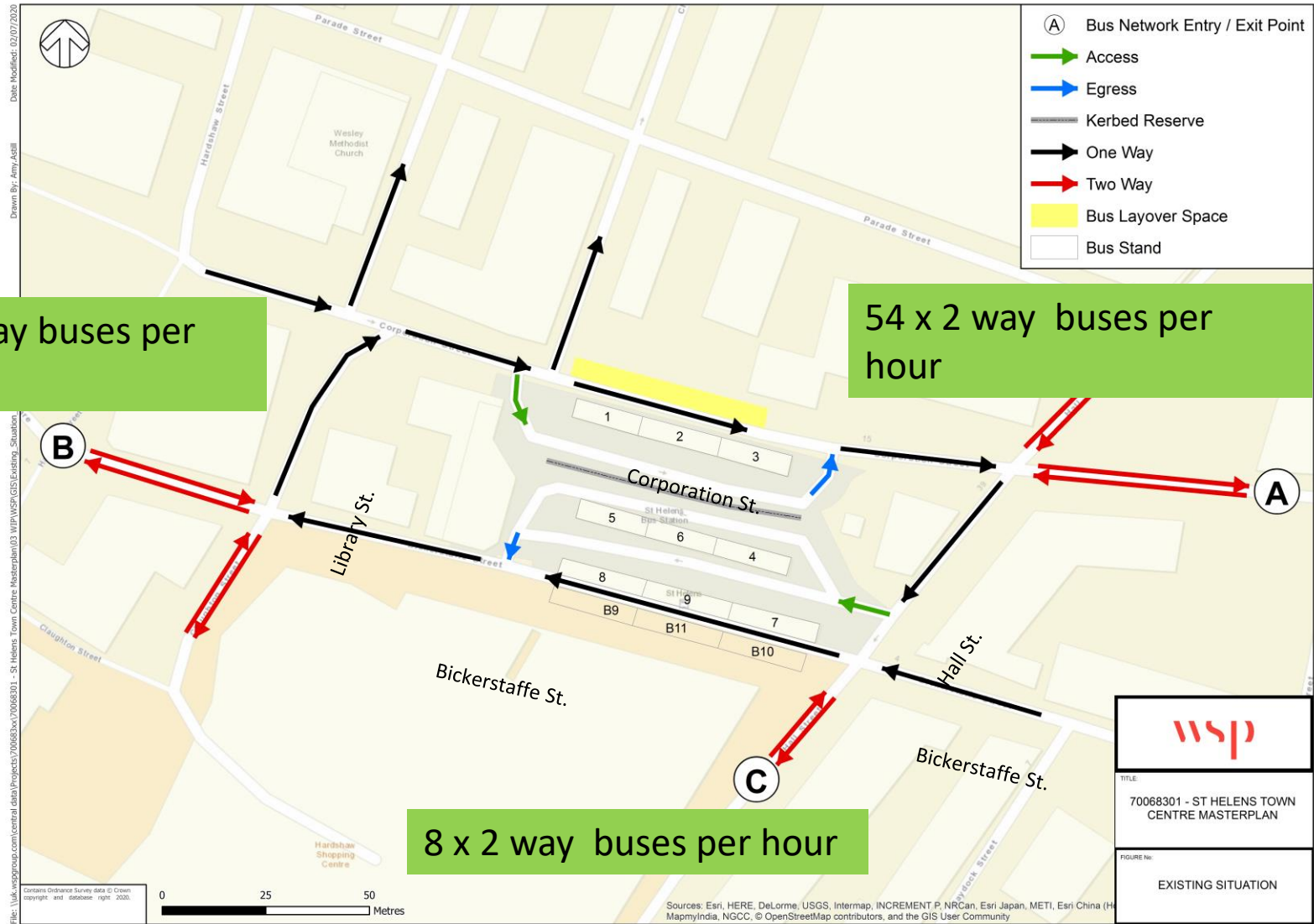

3



# Existing Traffic Flow and Bus Station Entry Points

4

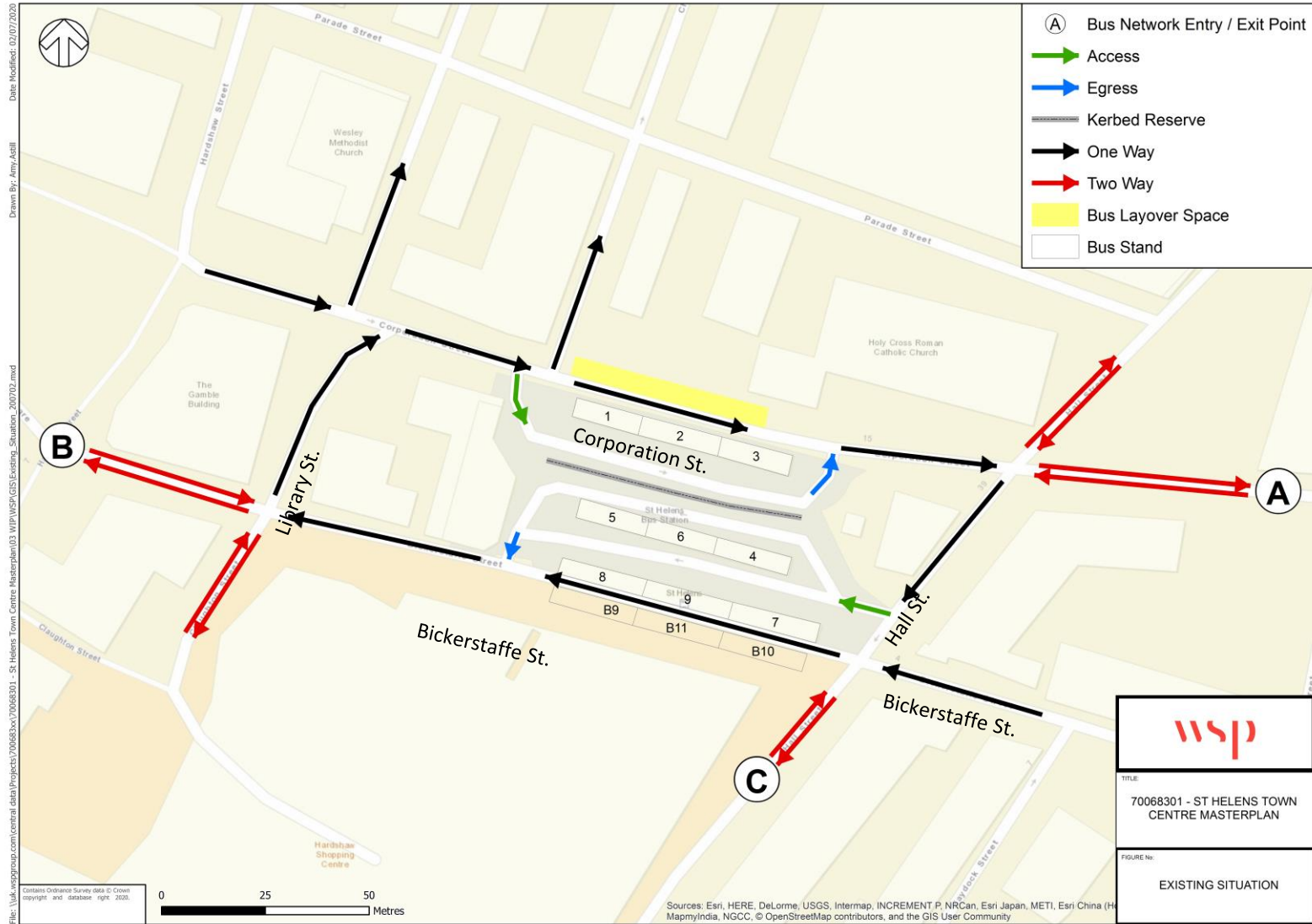

# Bus Station from Bickerstaffe Street



5

# Crossing on Bickerstaffe Street

6



# Properties on Bickerstaffe Street

7



# View Eastwards on Corporation Street





# Bus Layover on Corporation Street



# Bus Layover on Corporation Street



10

# Pedestrian Crossing - Corporation St Exit

11



# Hall Street looking southbound

12



# Informal Cycle Parking

13



# Service Vehicle Parking

14



# Millennium Centre, Hall Street



15

# Pedestrian in Busway





# Pedestrians in Busway



17

# LCRCA Option 2 (Waterman, 2019)

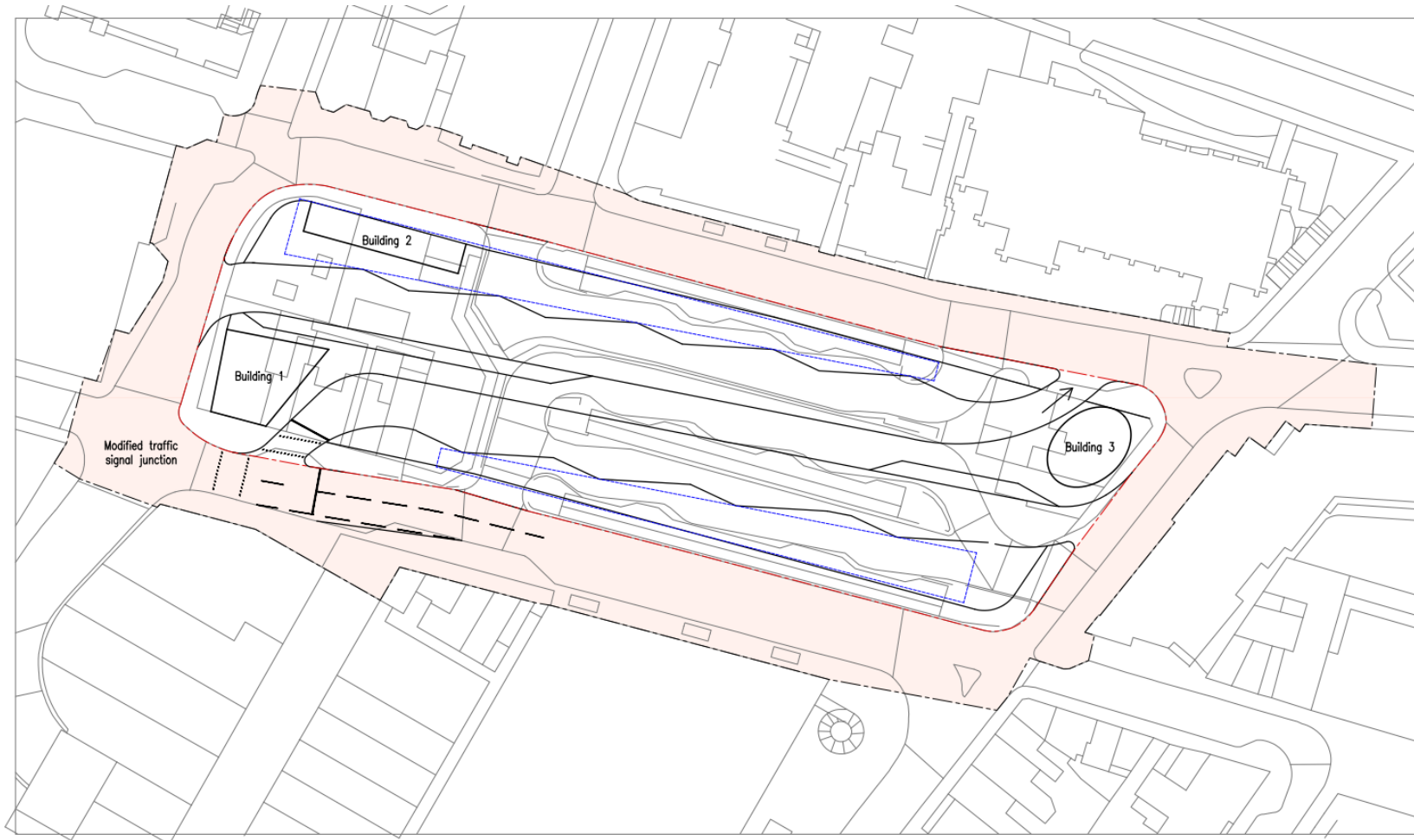

18

# LCRCA Option 5 (Waterman, 2019)

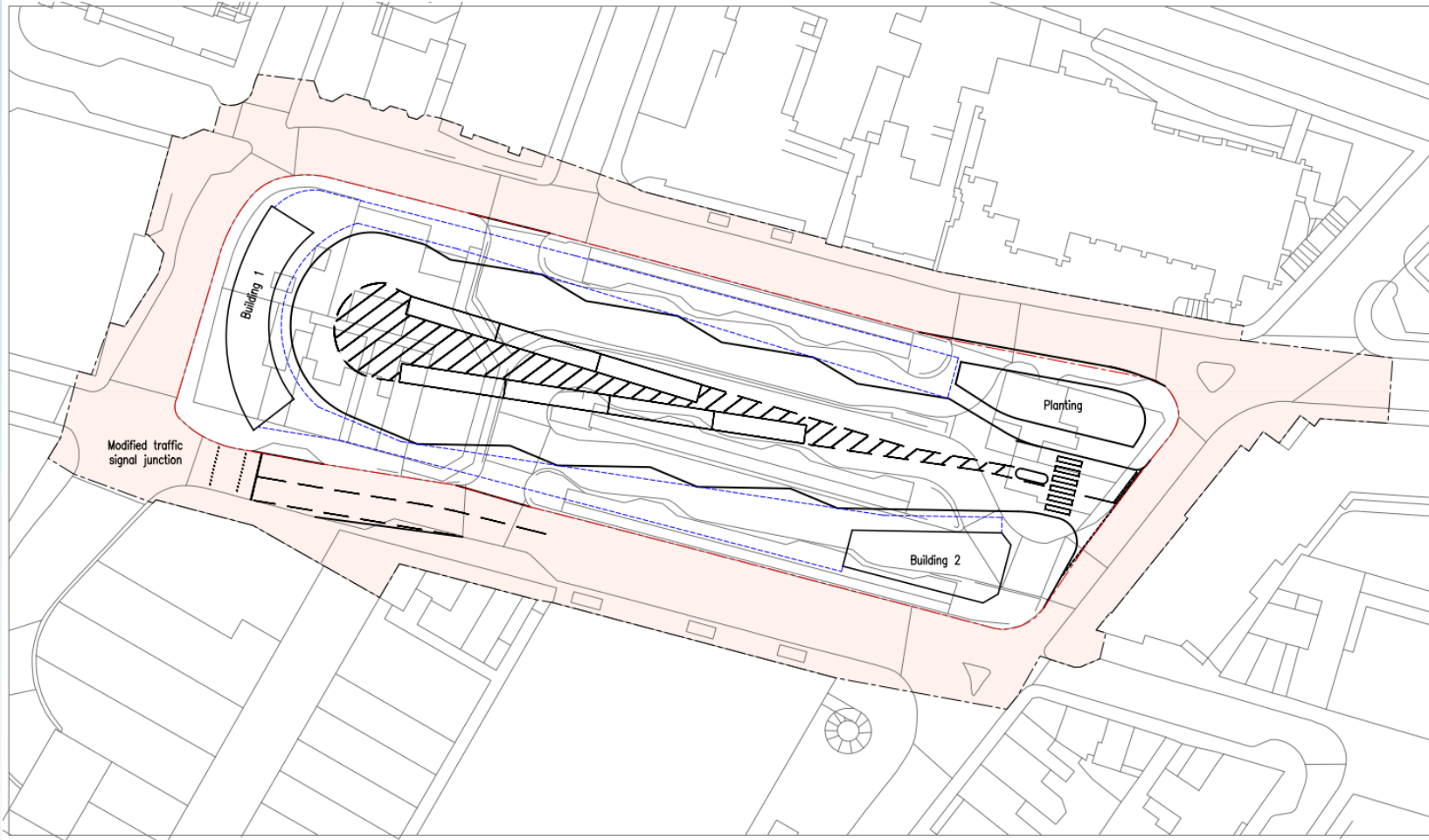

19

# Potential Bus Station Locations

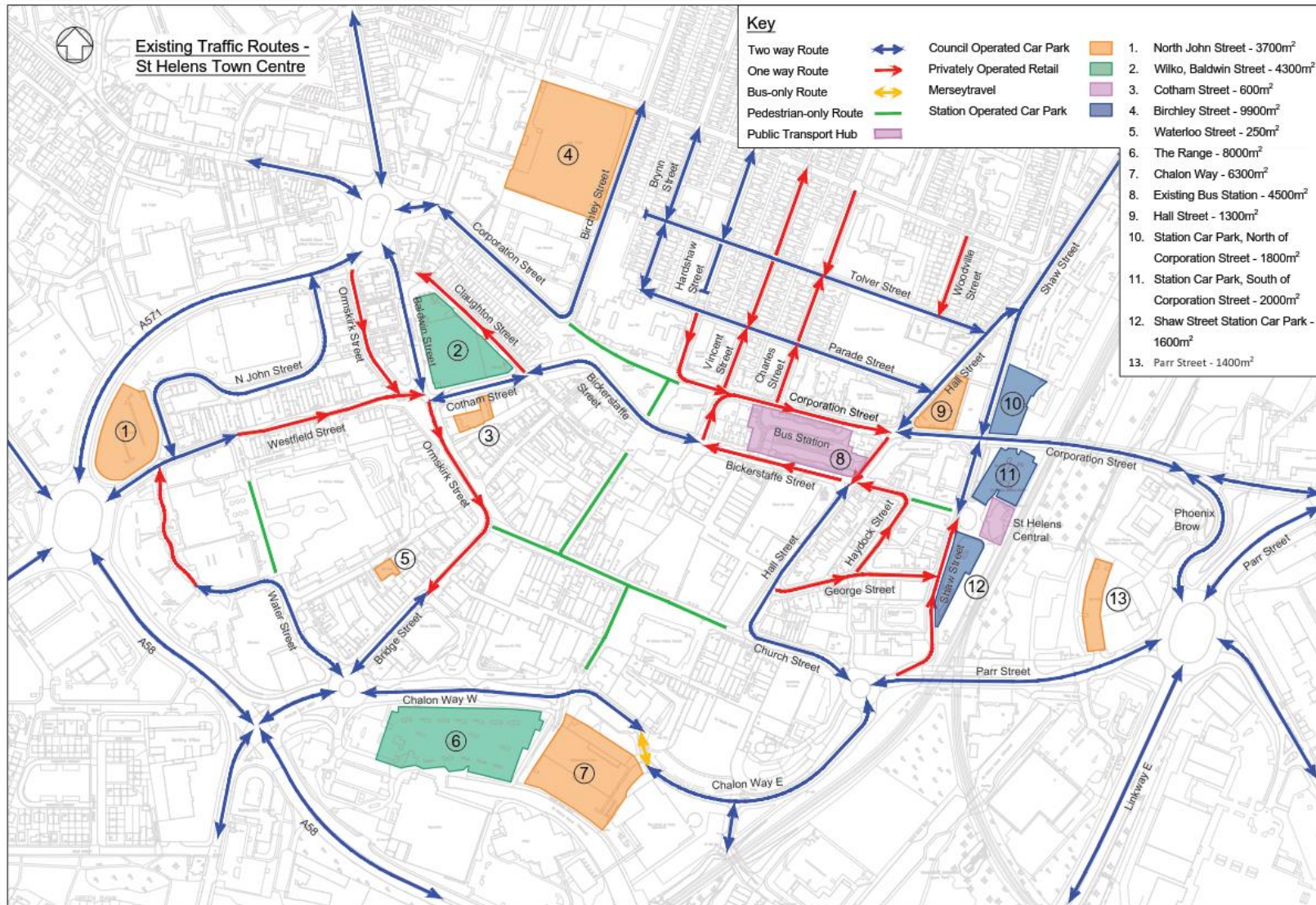

20

# Option 1

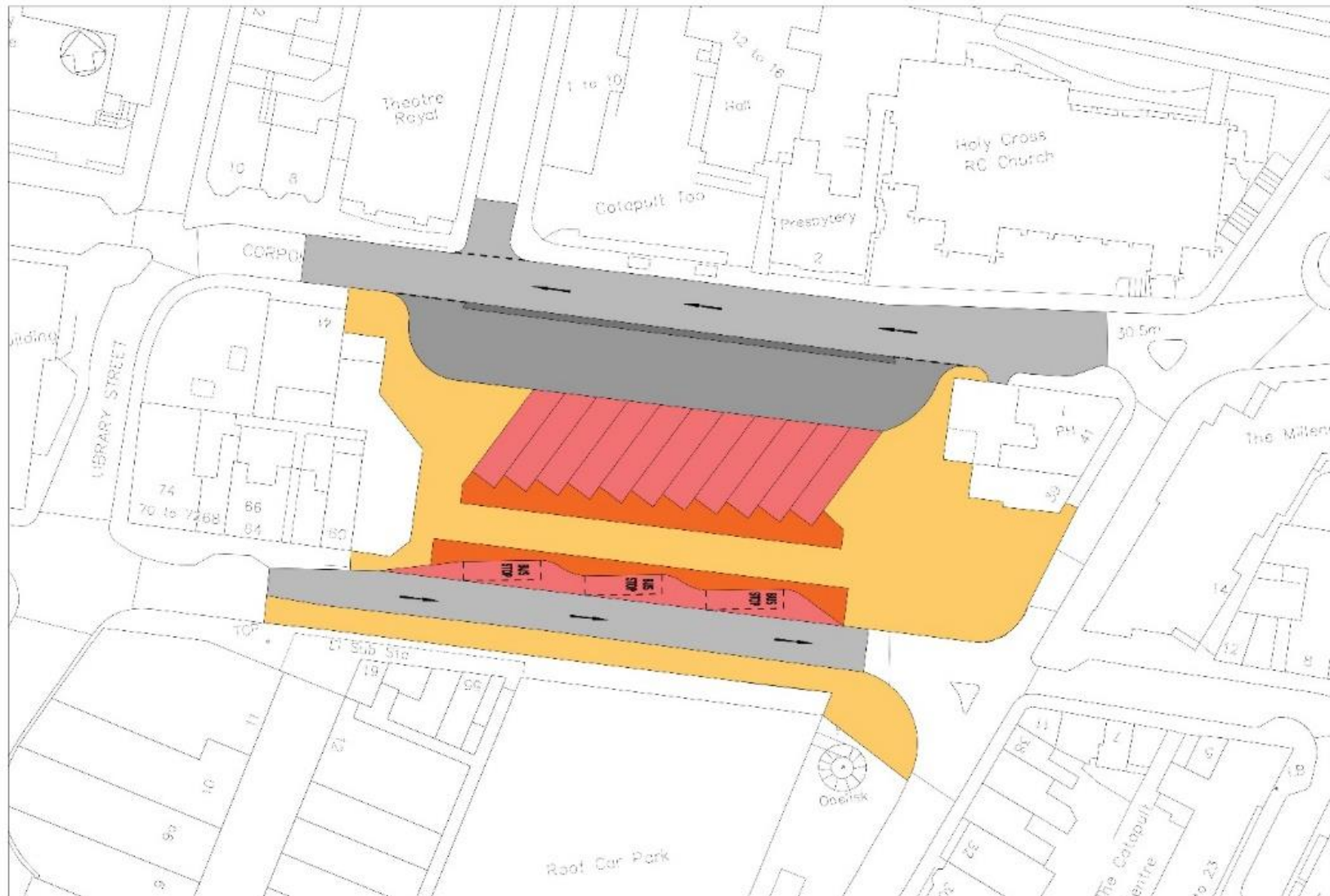

21

# Option 1A

22

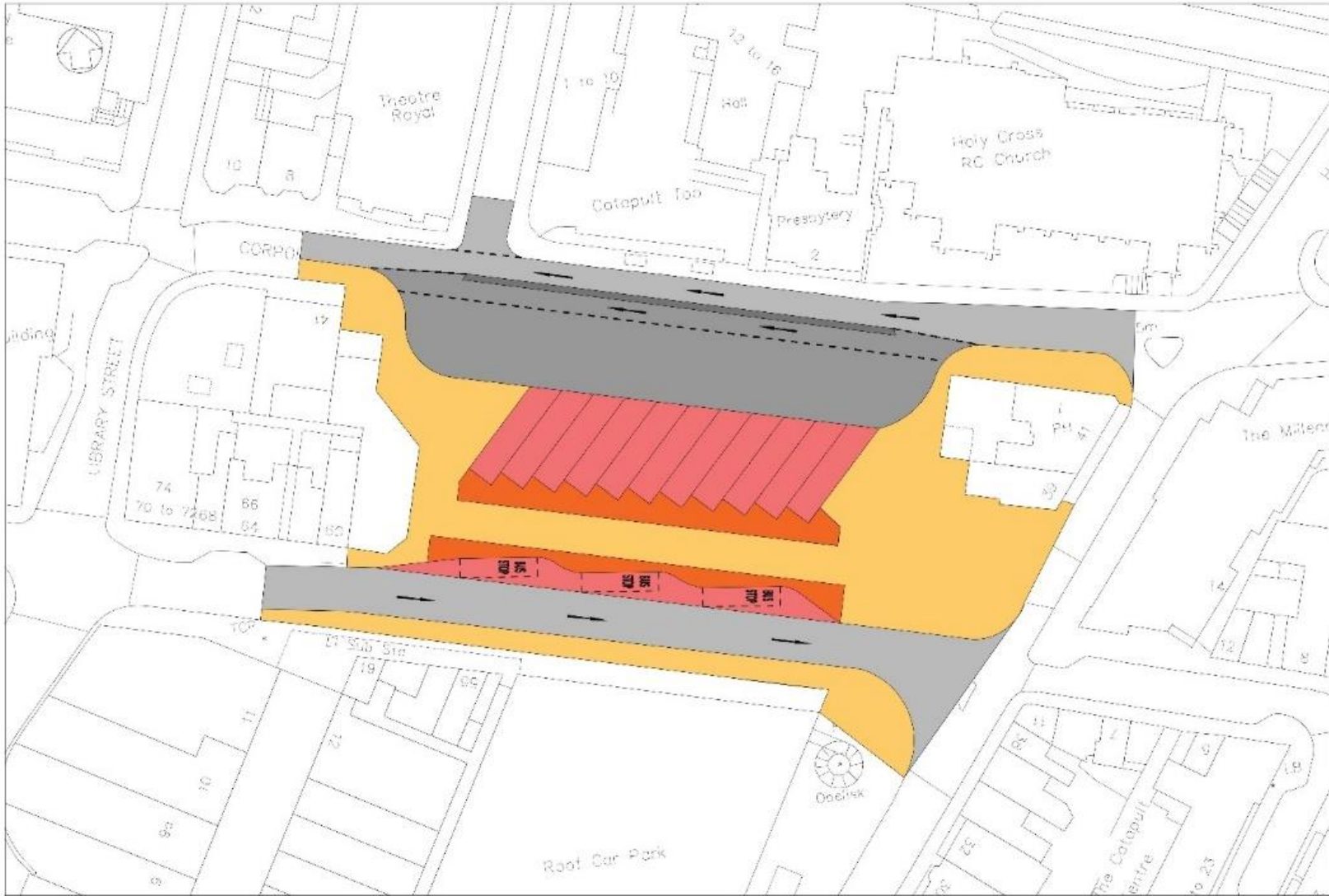

# Option 2

23

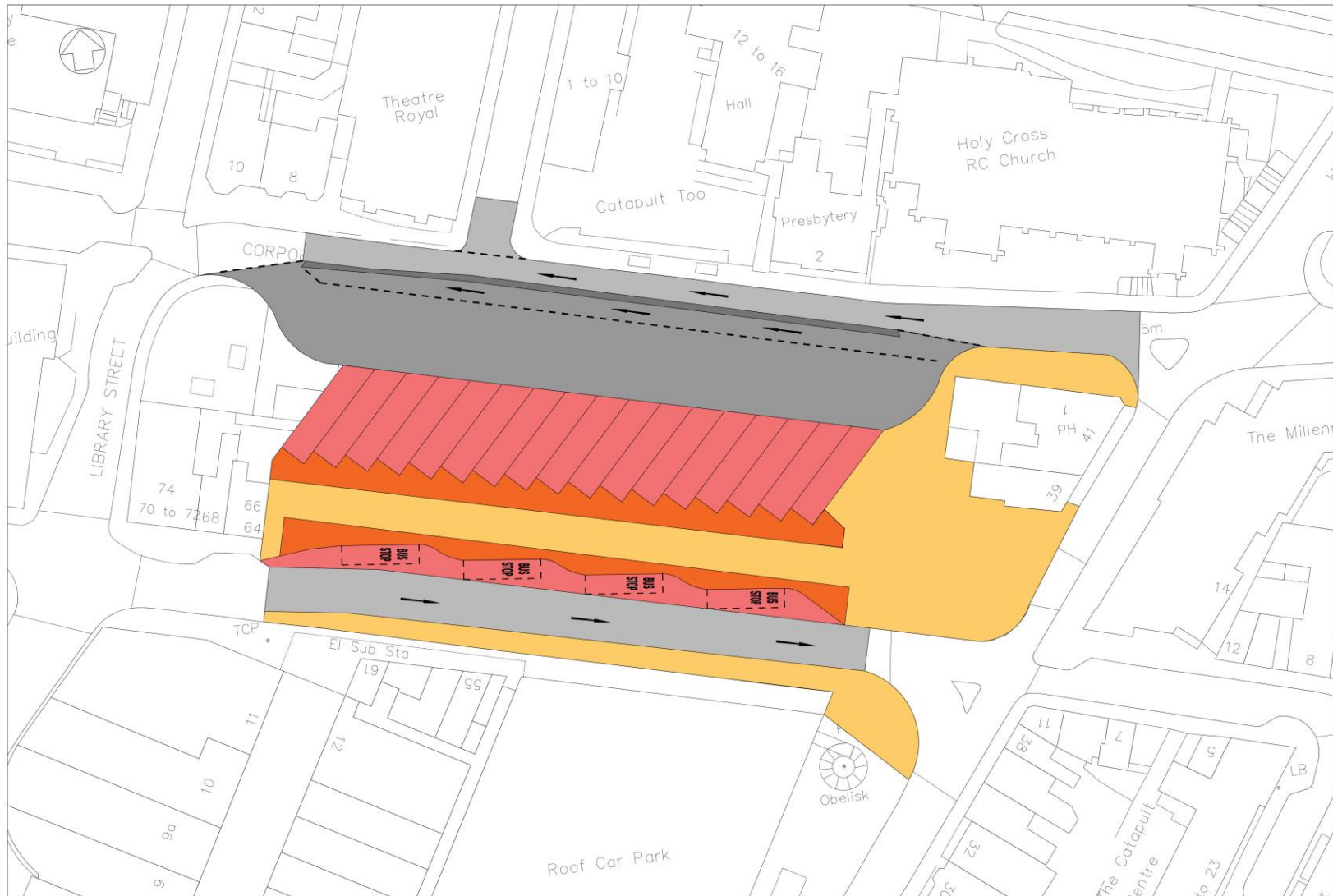

# Option 3

24

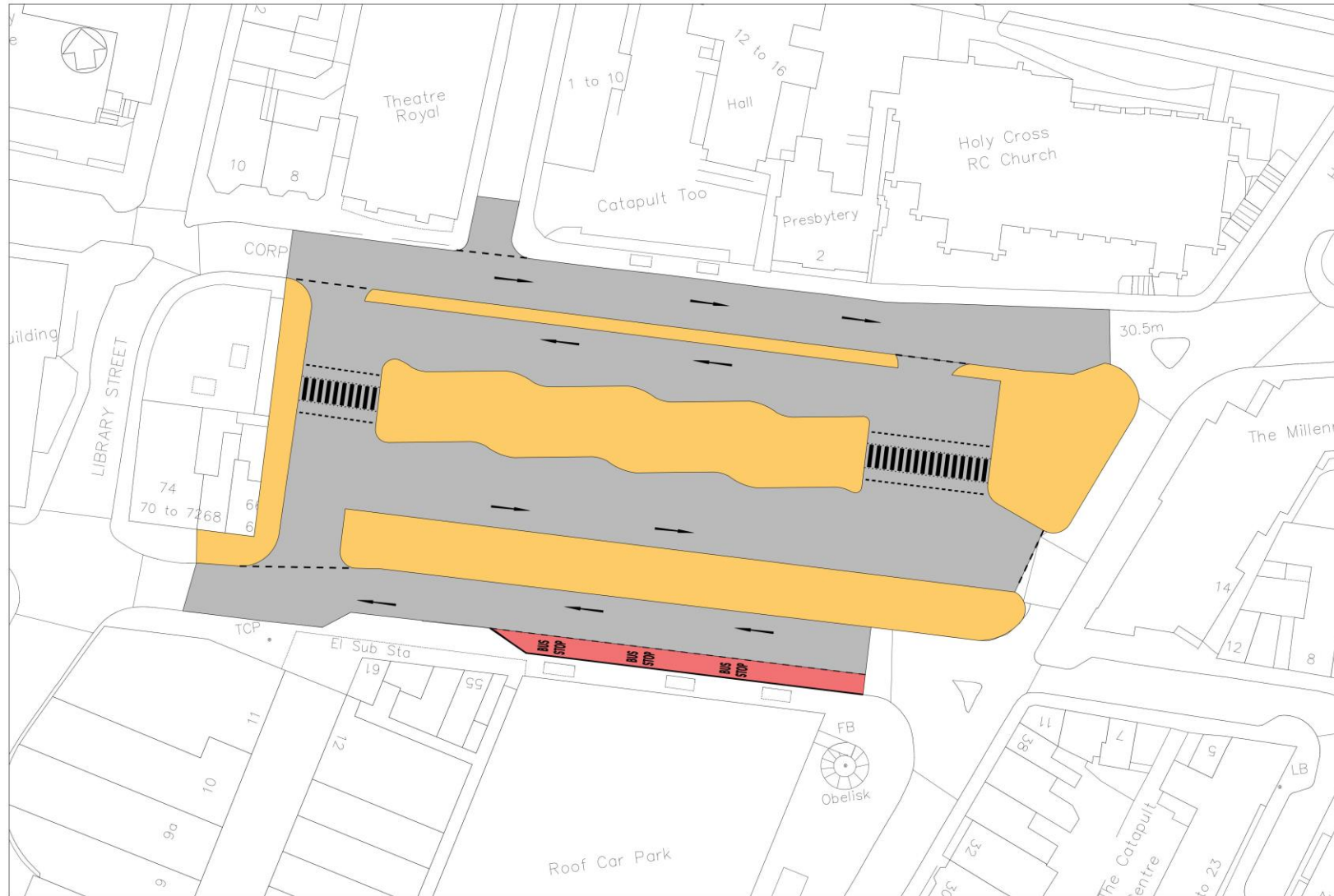



# Option 4

25



# Option 5

26



# Option 6

27



# Option 7

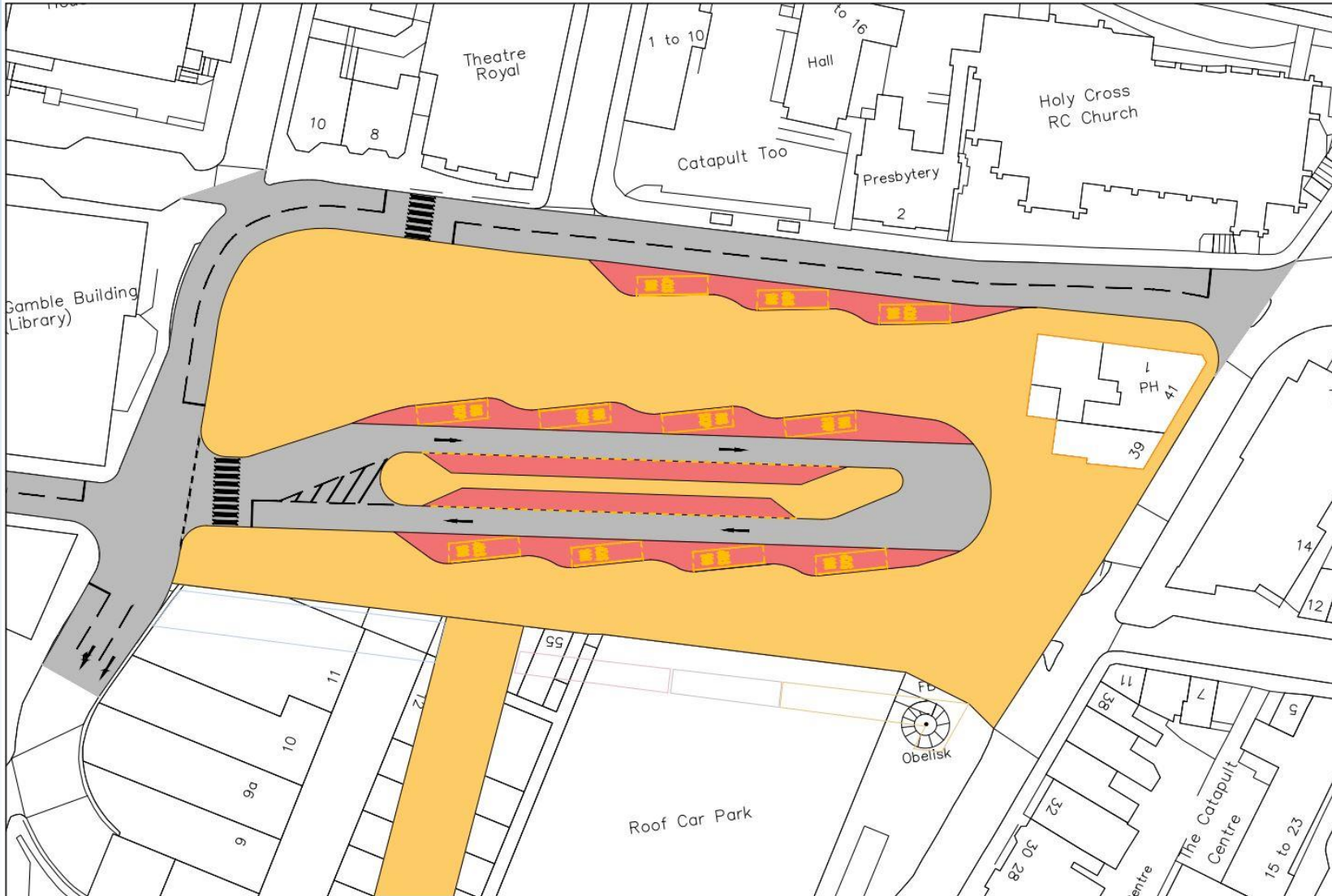

28

# Option 8



# Option 9

30

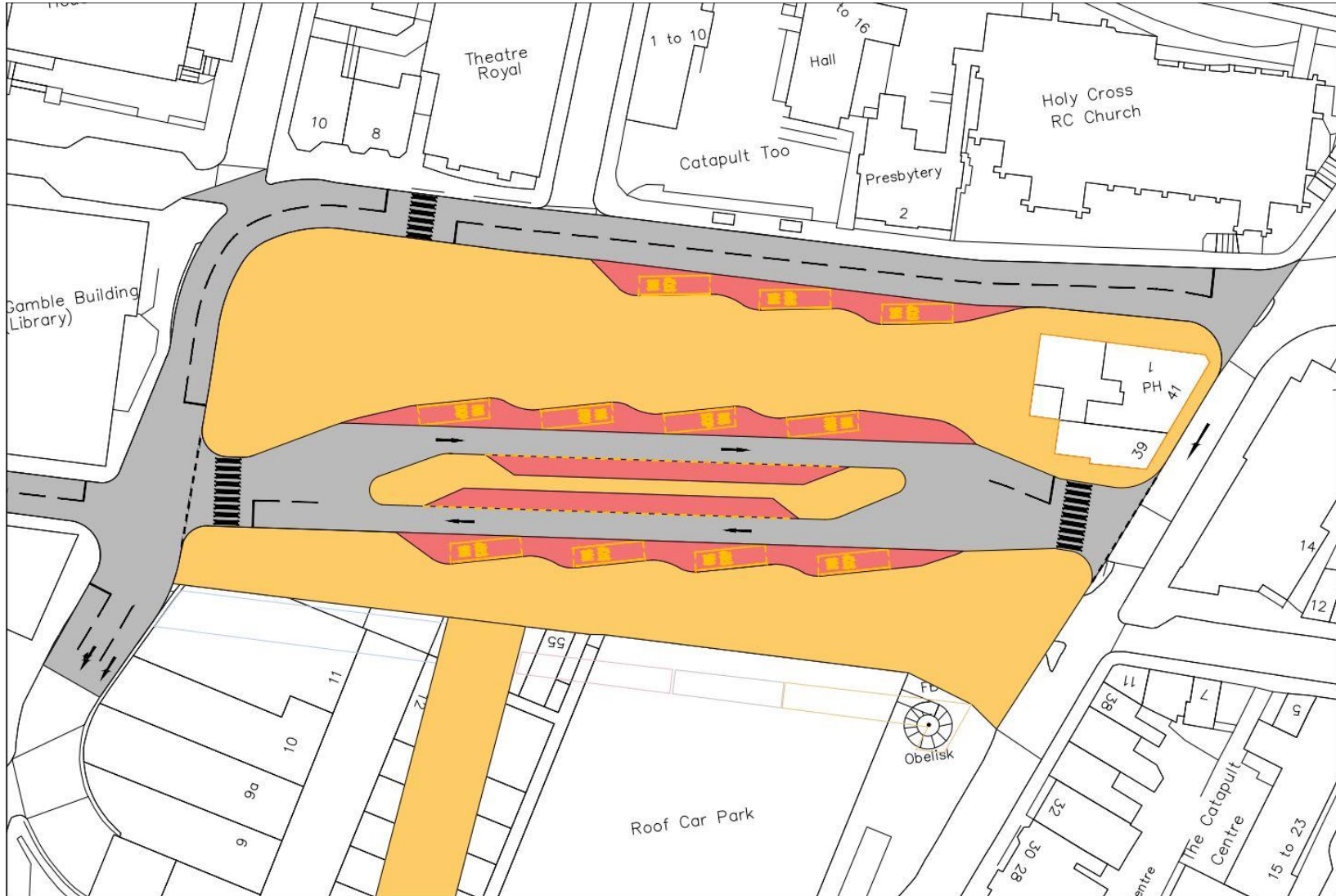

# Option 9a

31

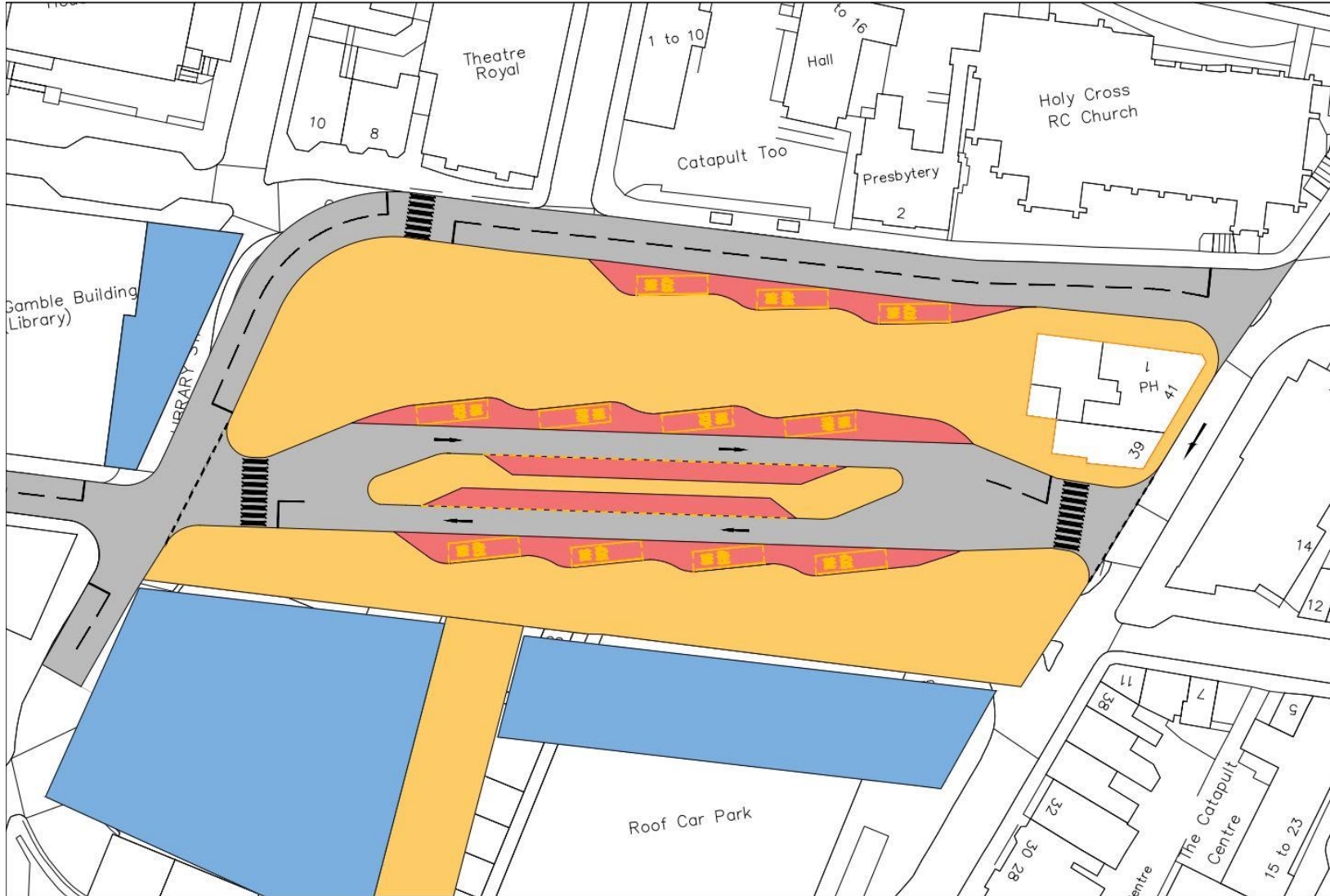

# Option 10

32

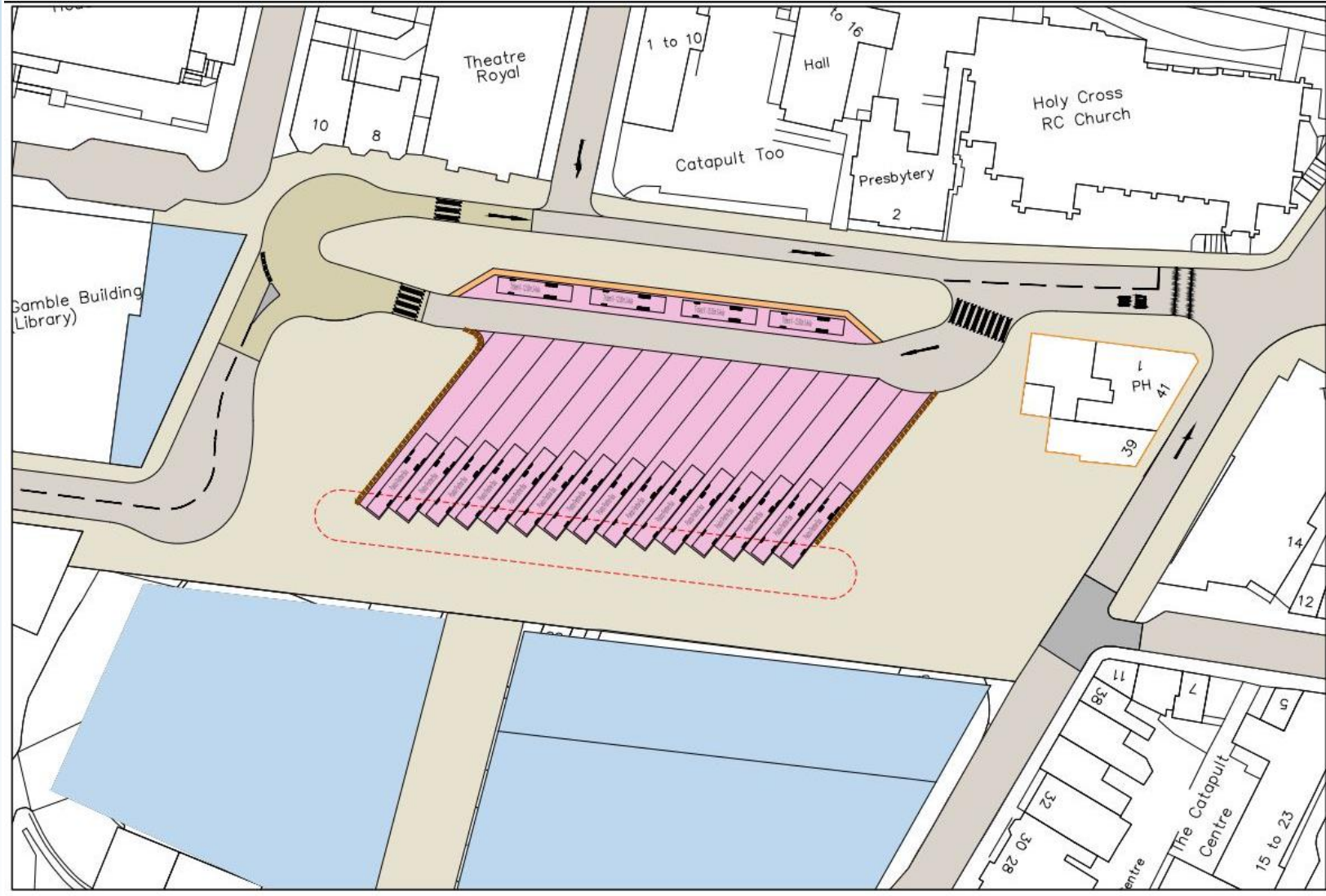



# Option 7A

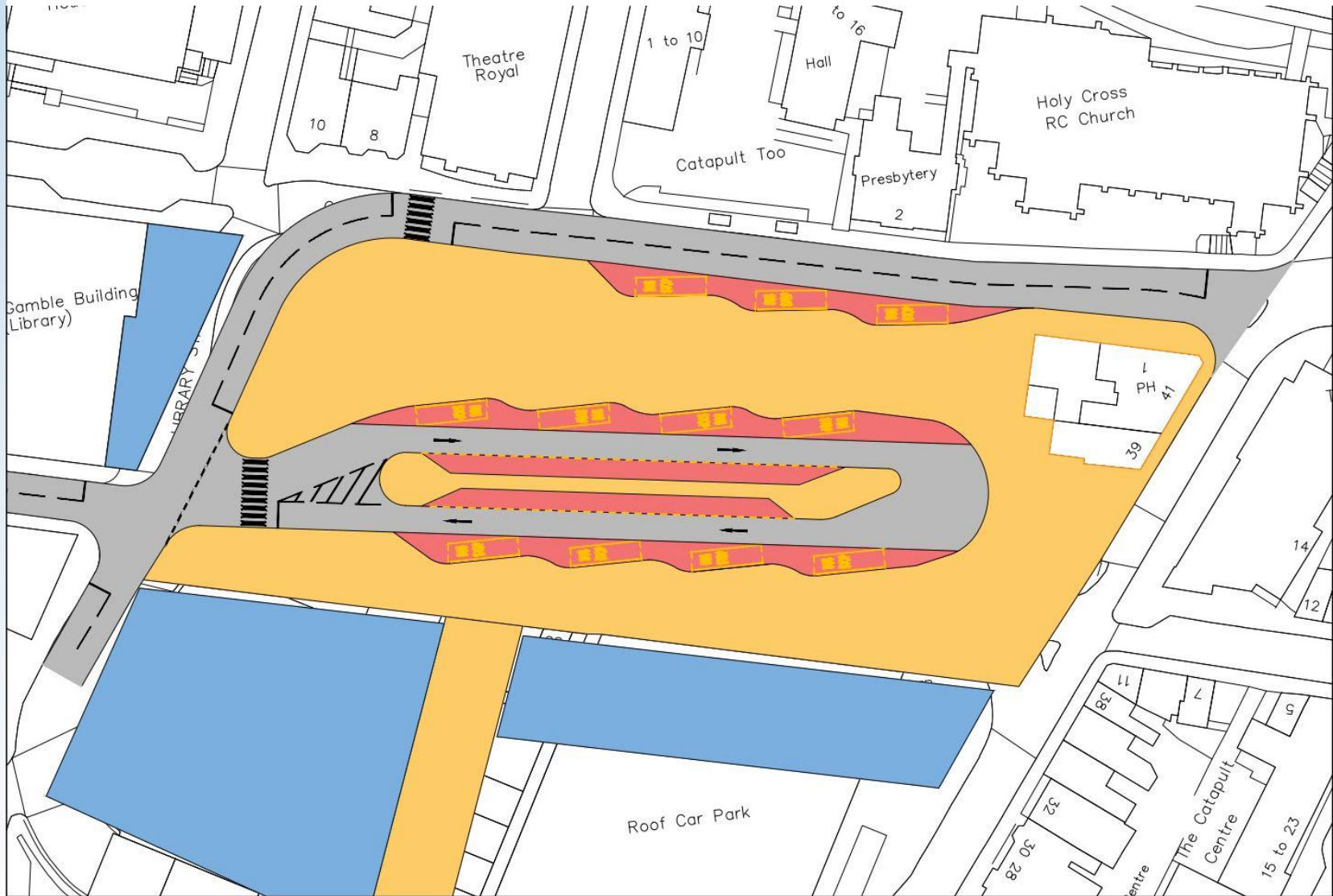

33

# Option 7B

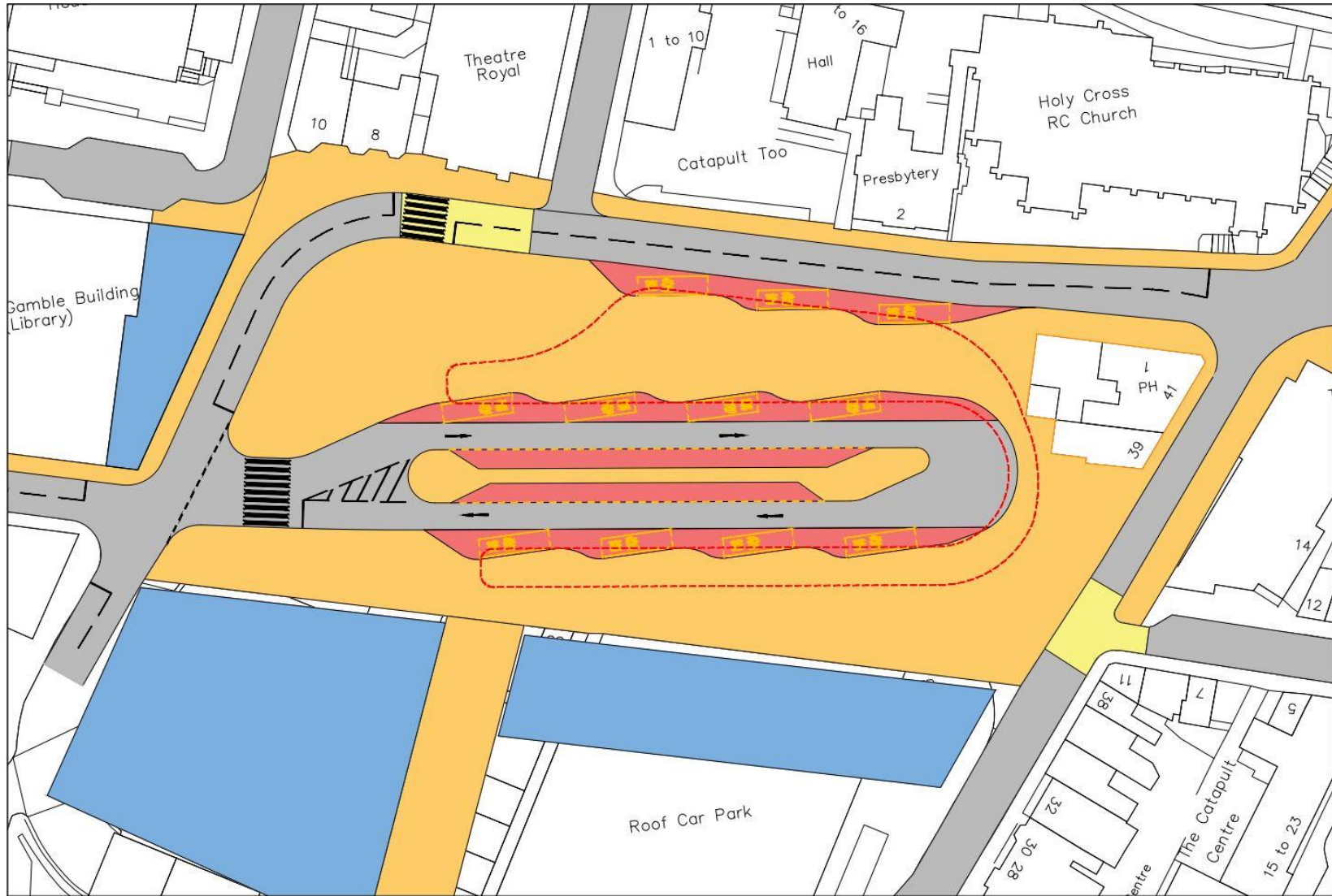

34

# Option 7C

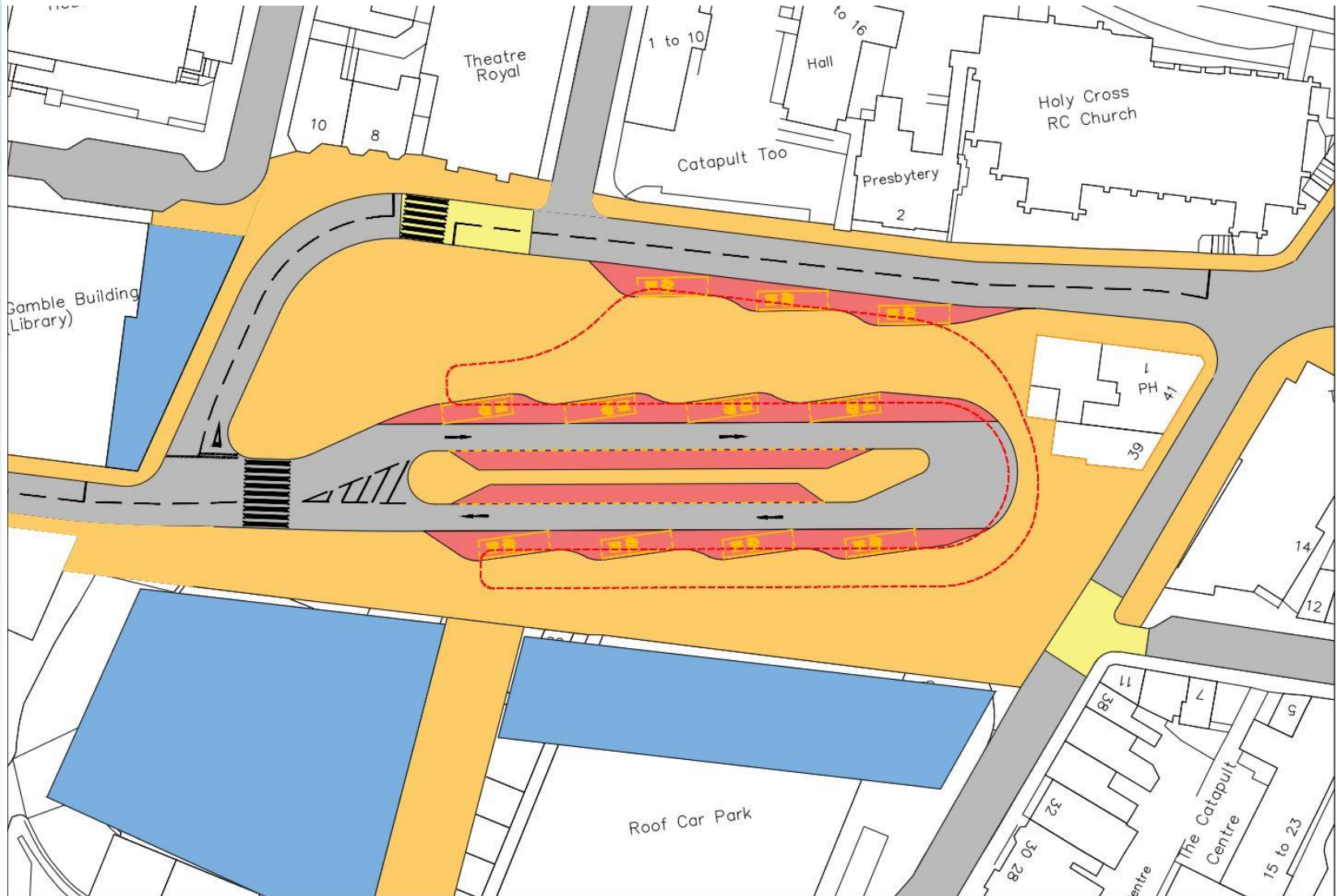

35

# Option 7D

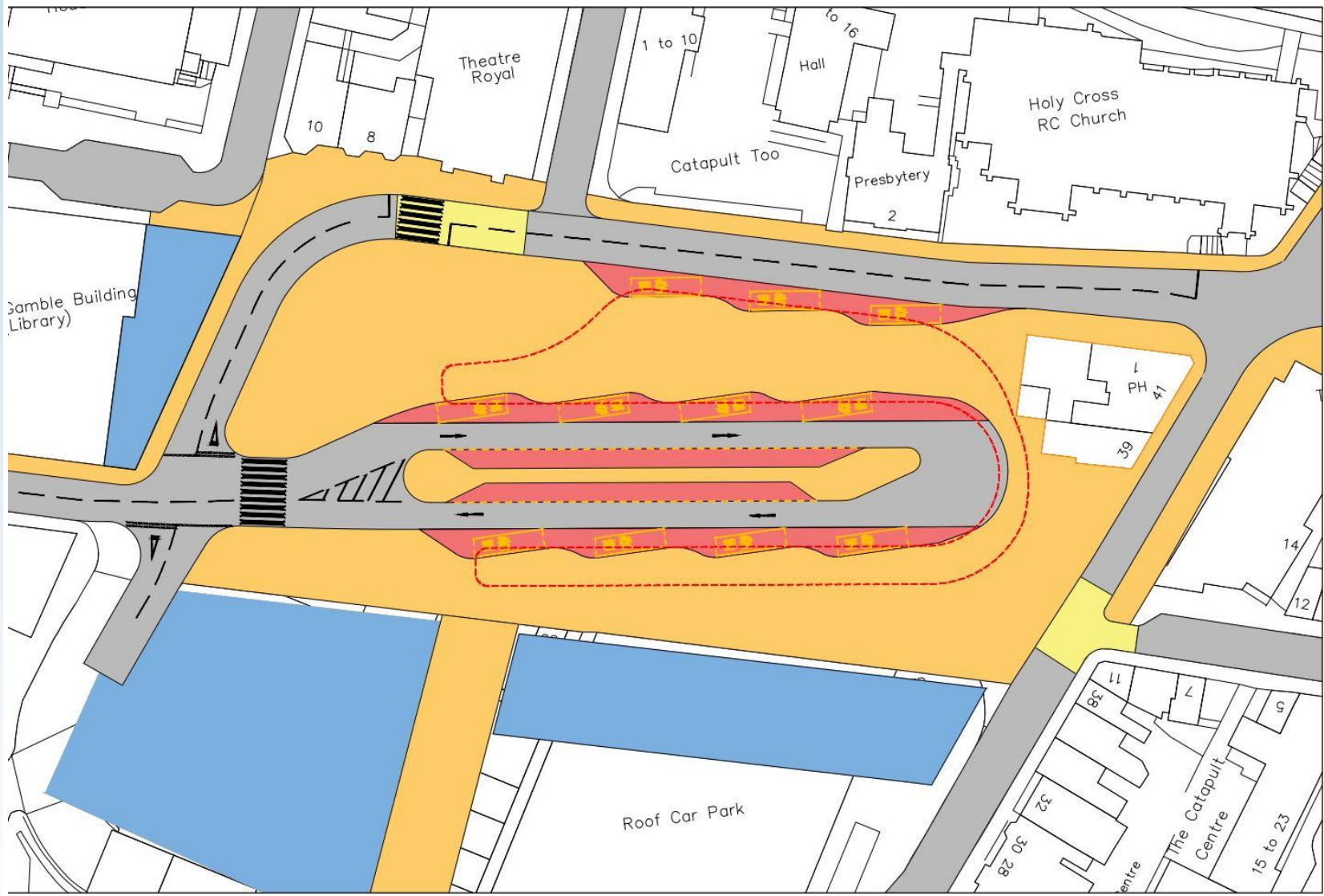

36



# Option 7E

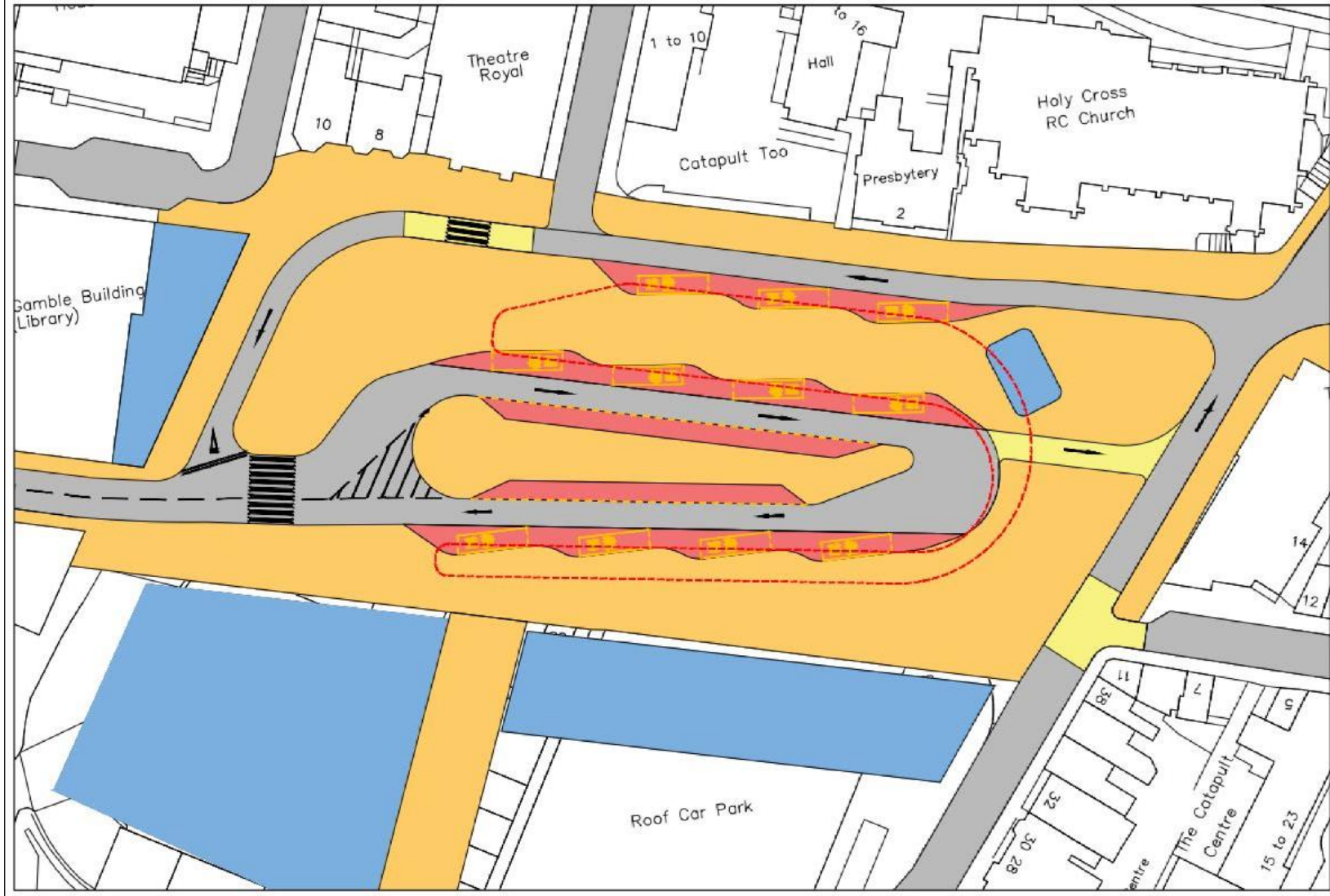

37

# Option 7F

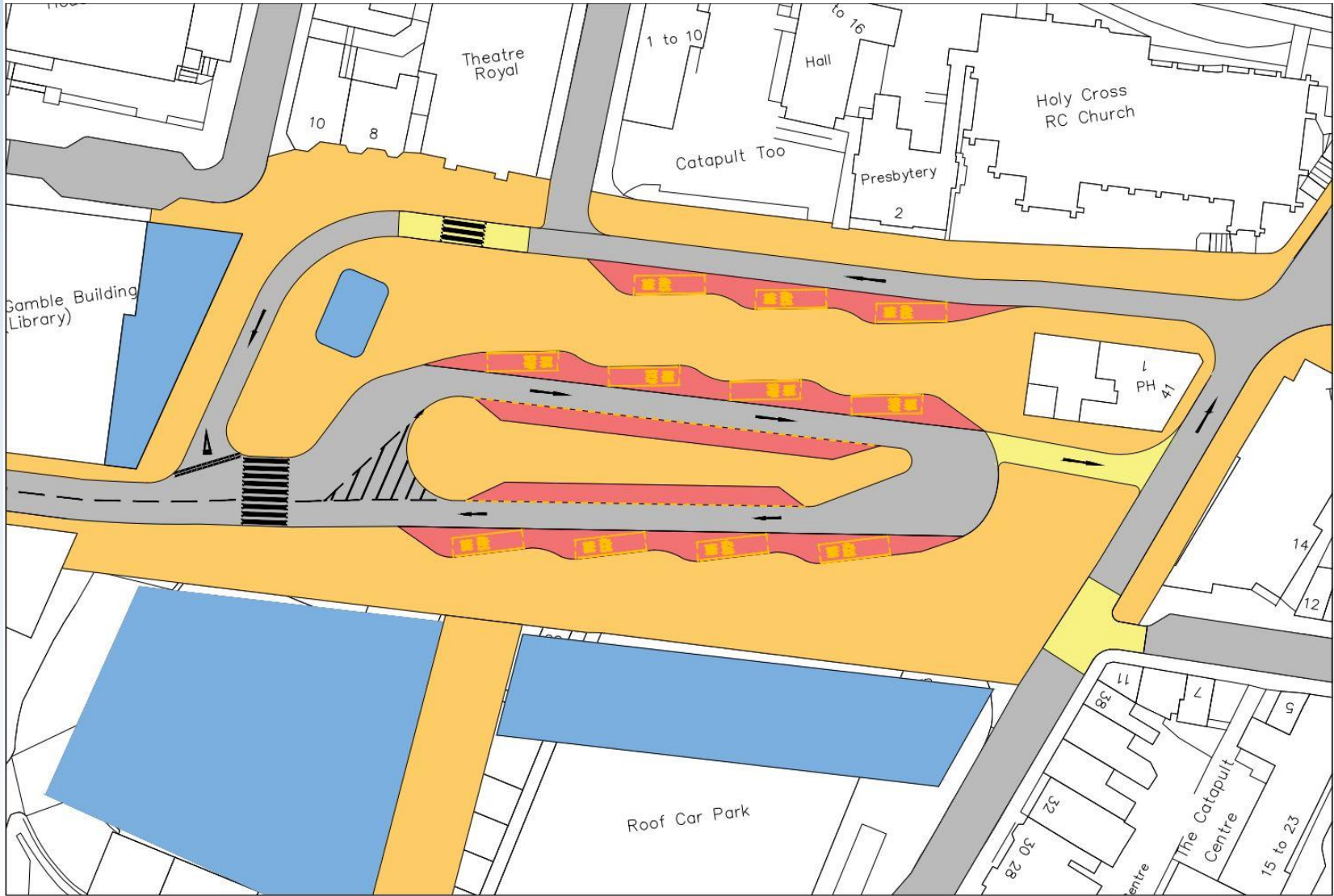

38

# Option 7G

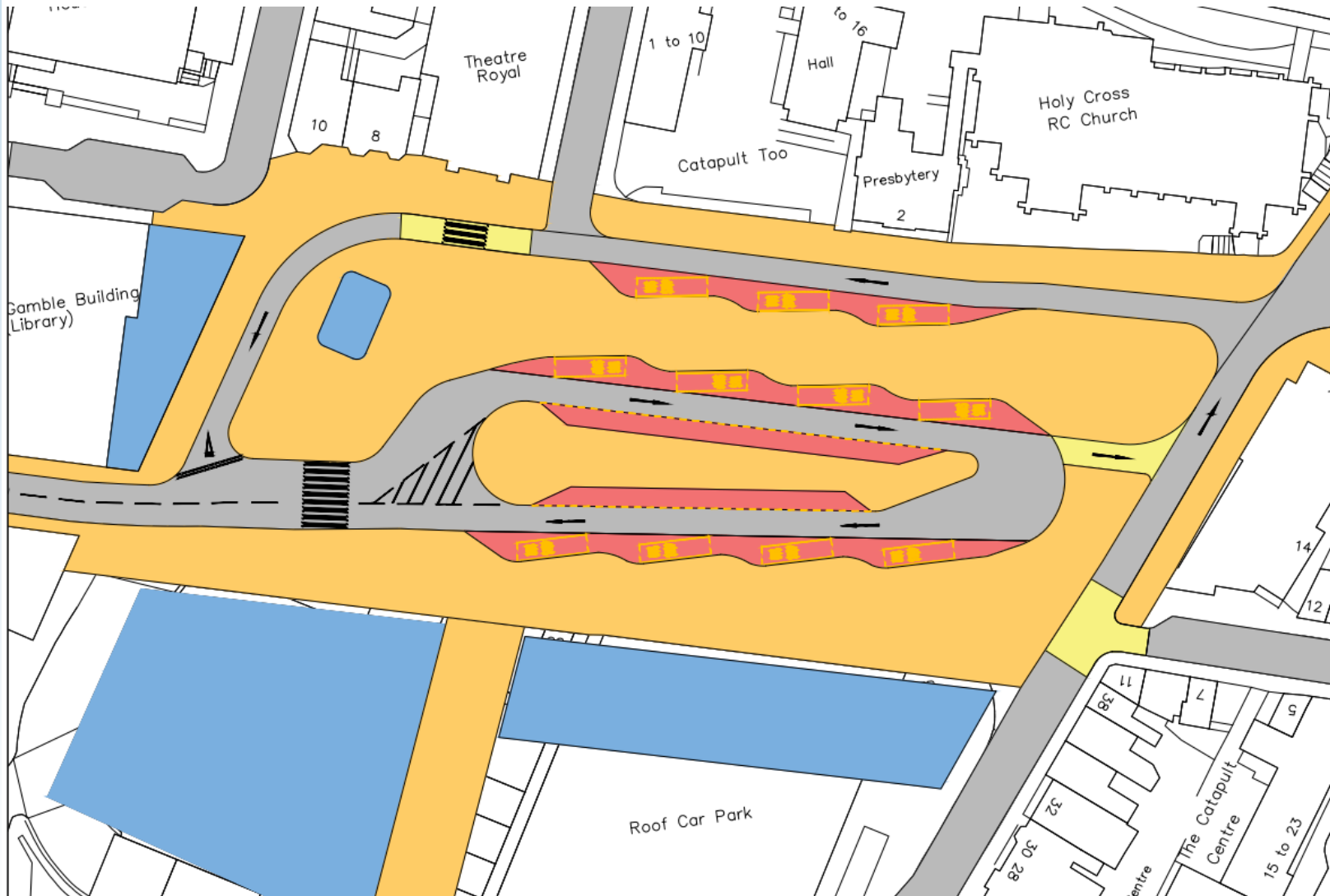

# Option 7H

40

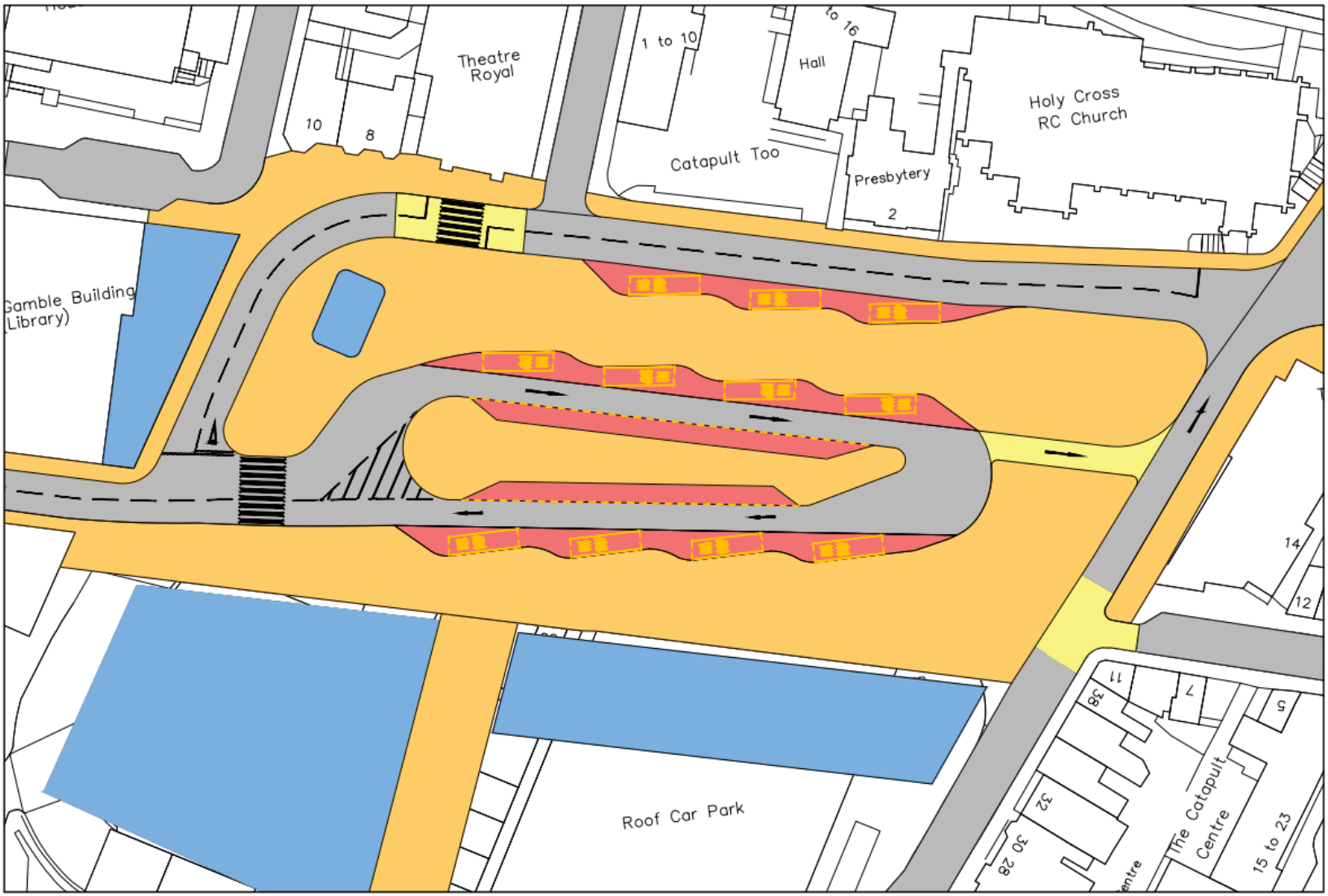



# Option 71

41

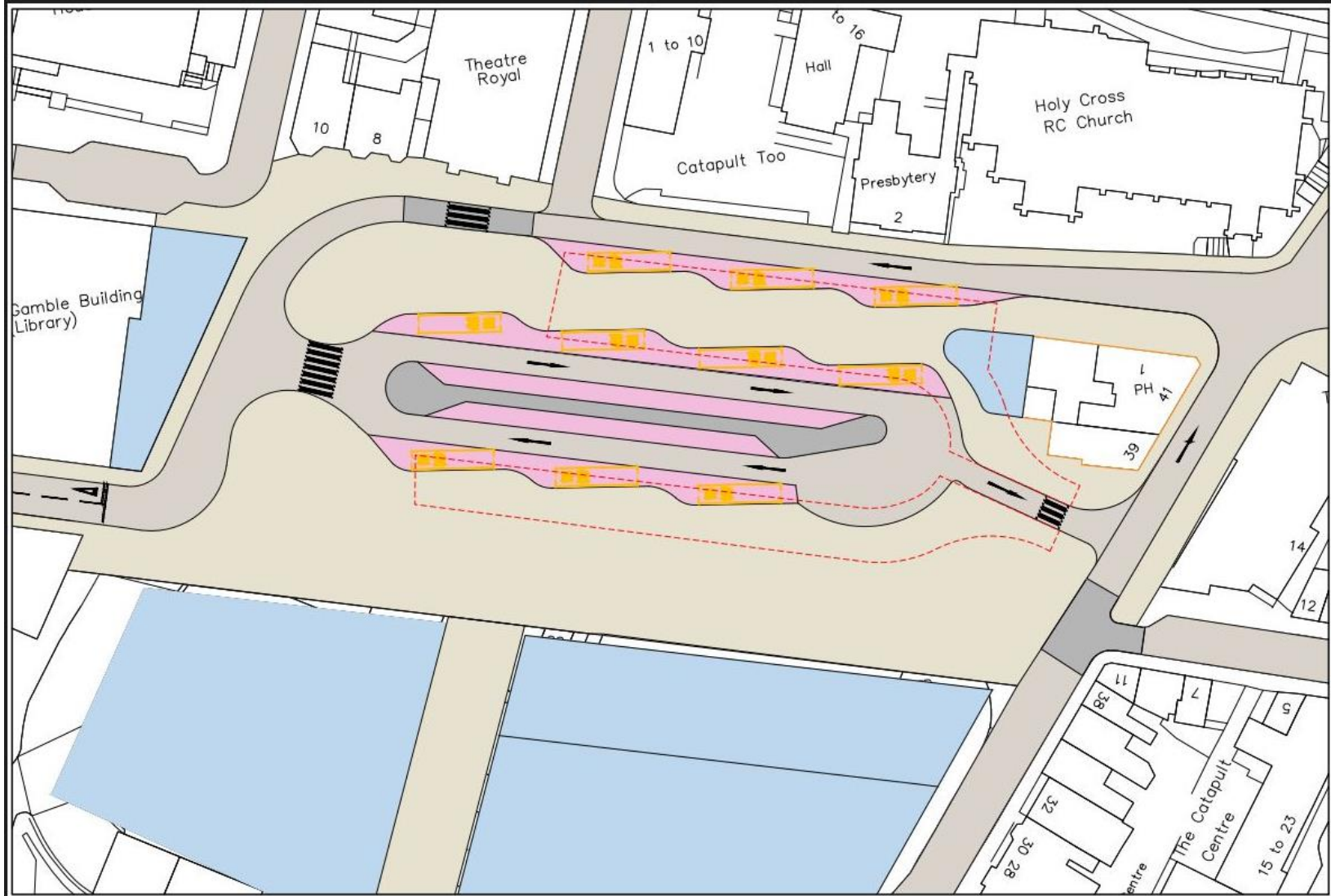

# Option 7J

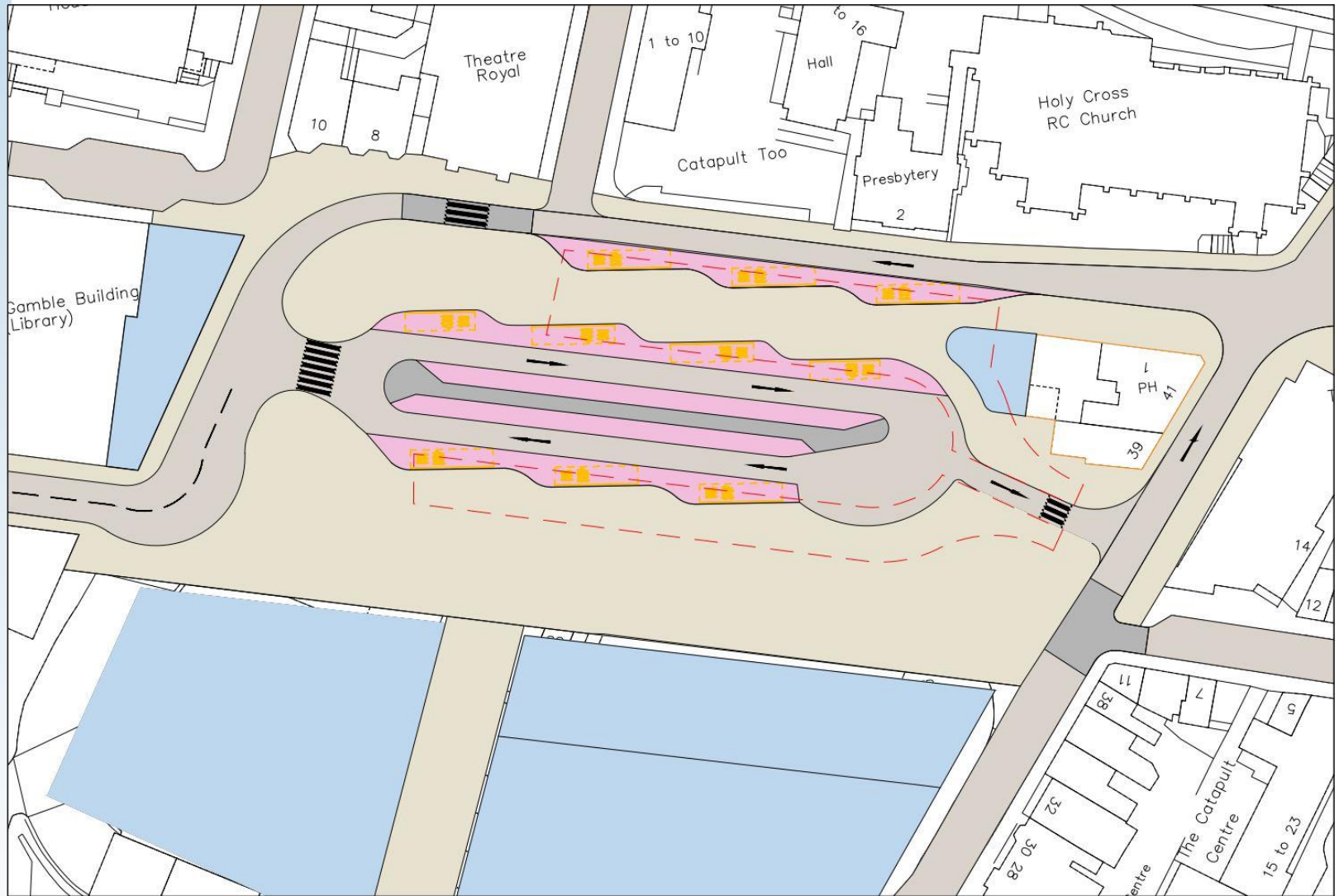

42

# Option 7K

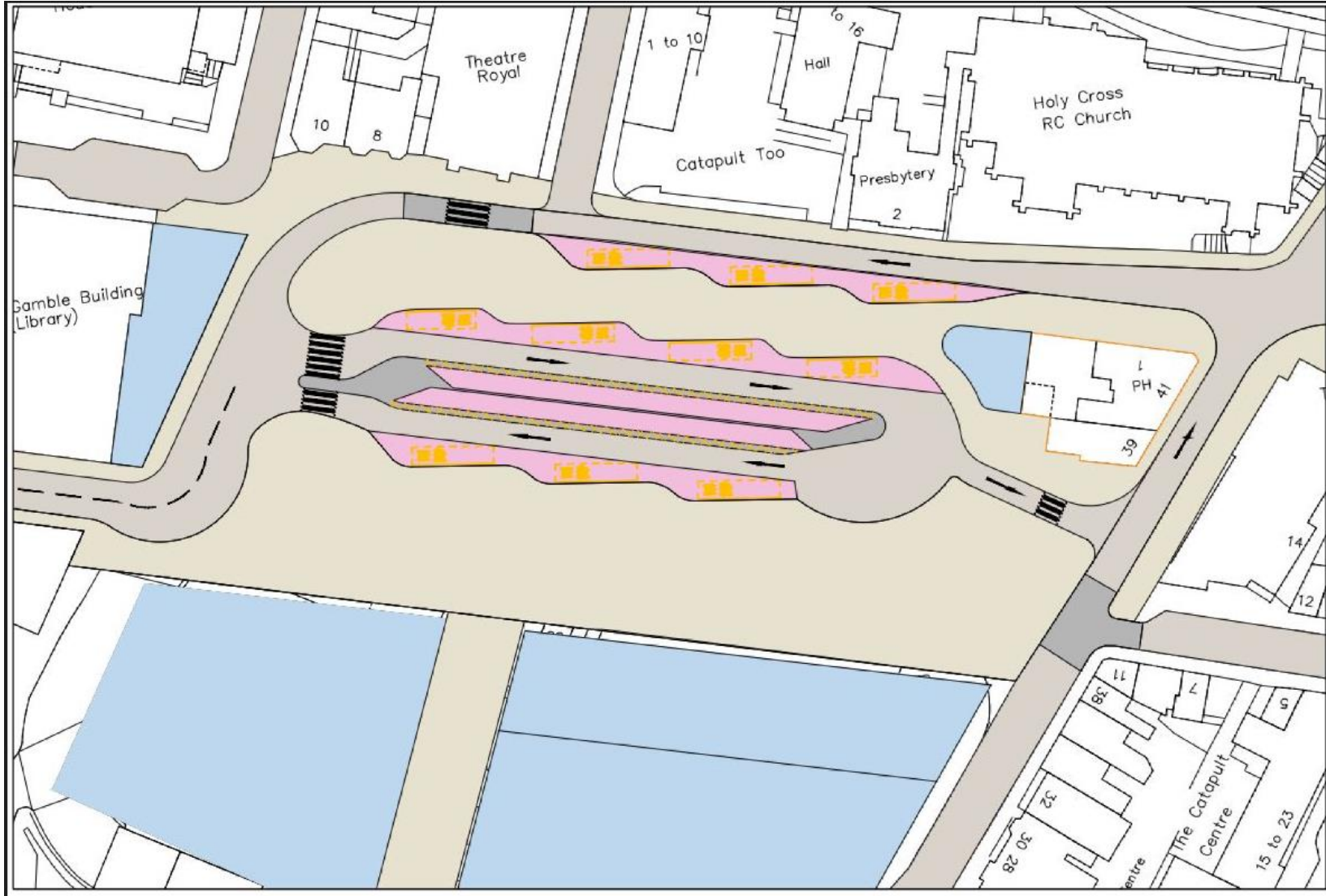

43

# Option 7L

44

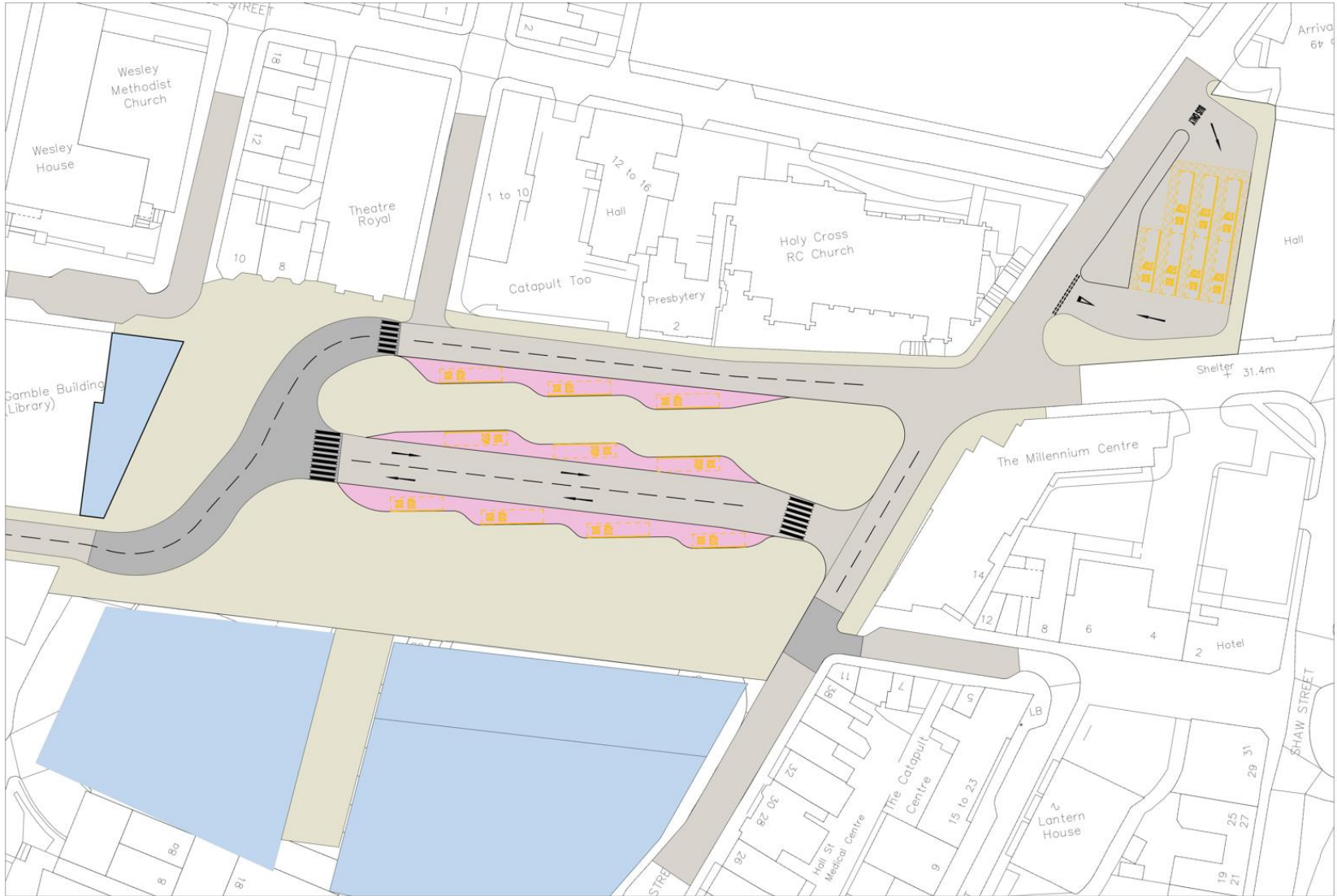

# Option 7M

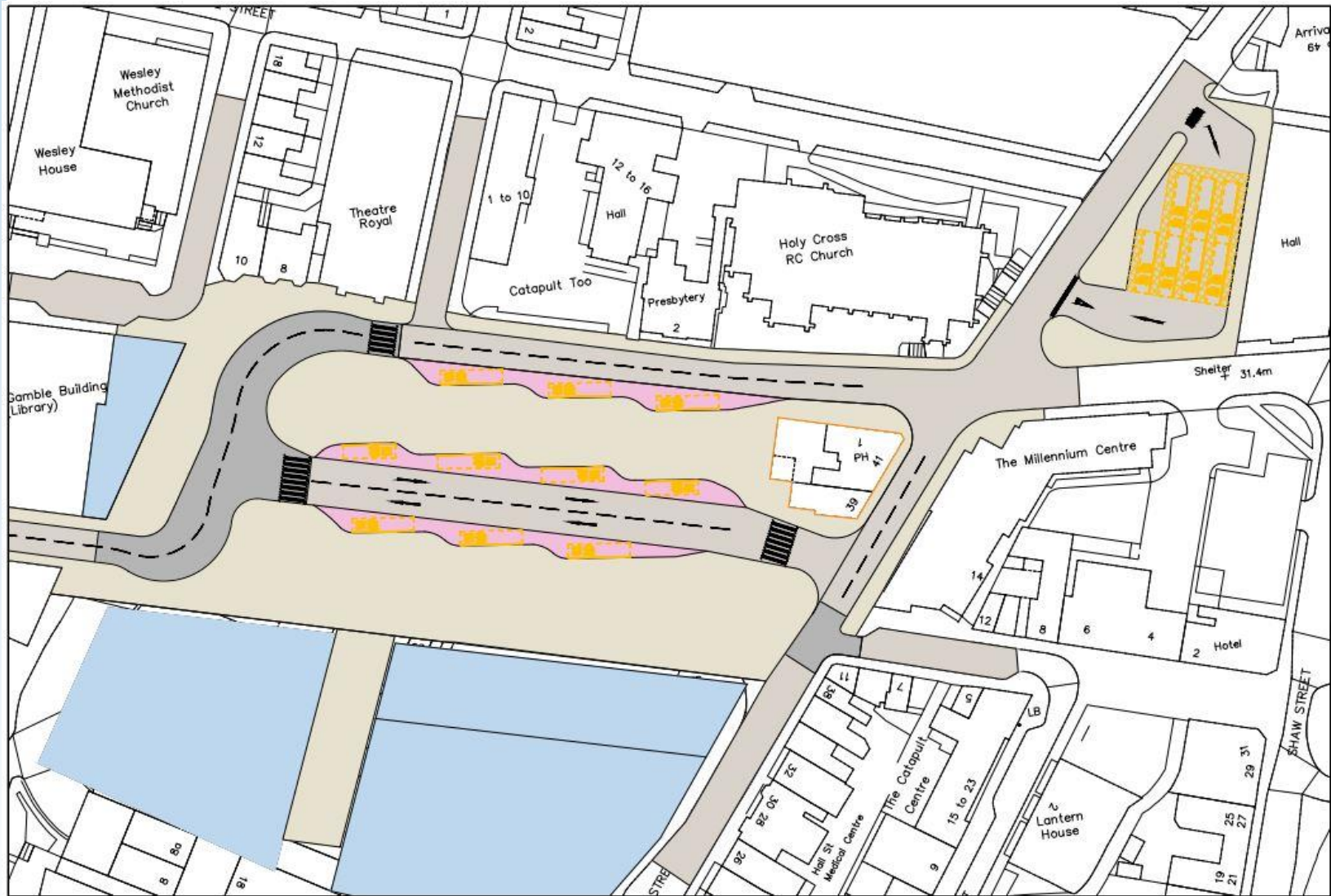

45

# Option 7N

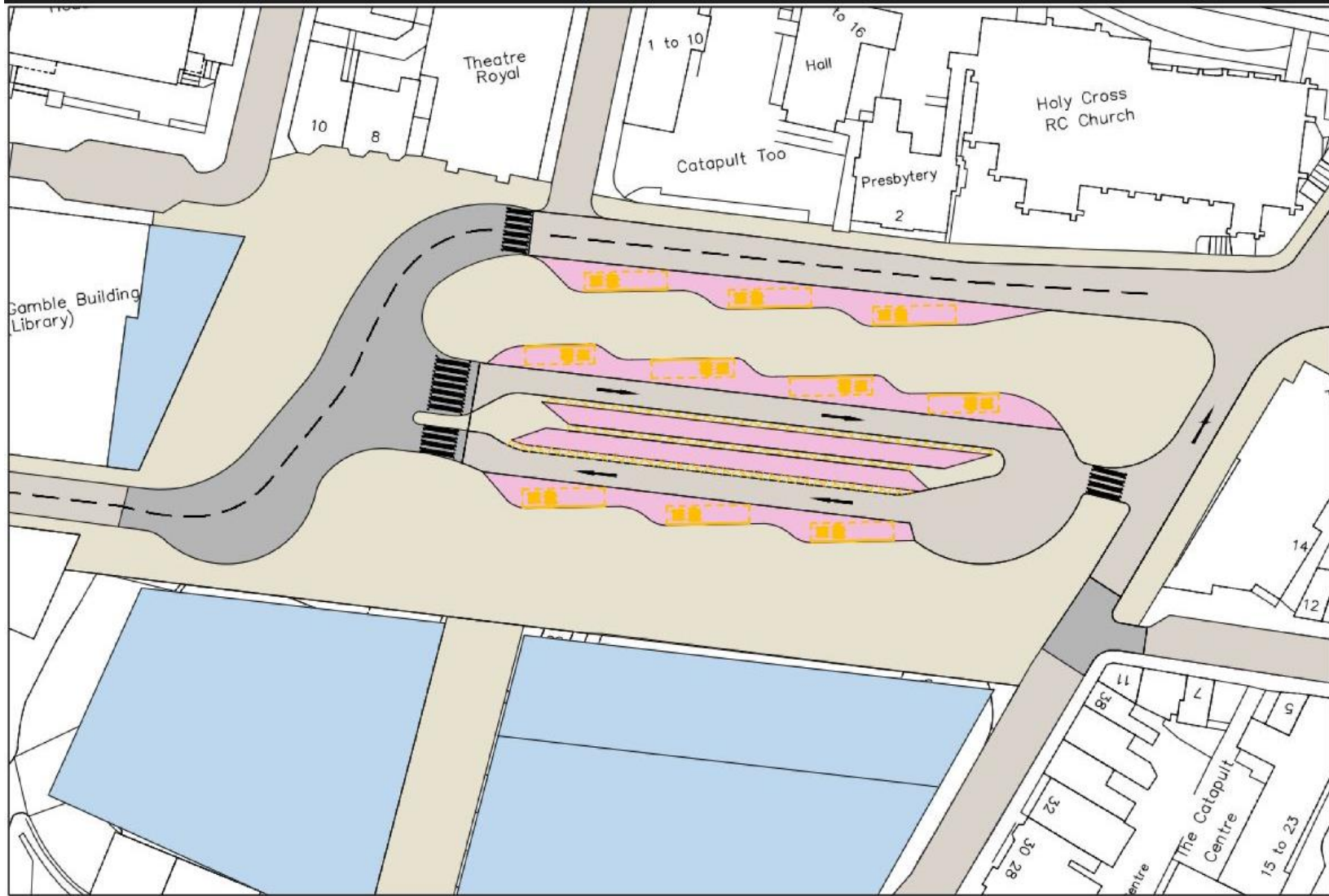

46

# Option 70

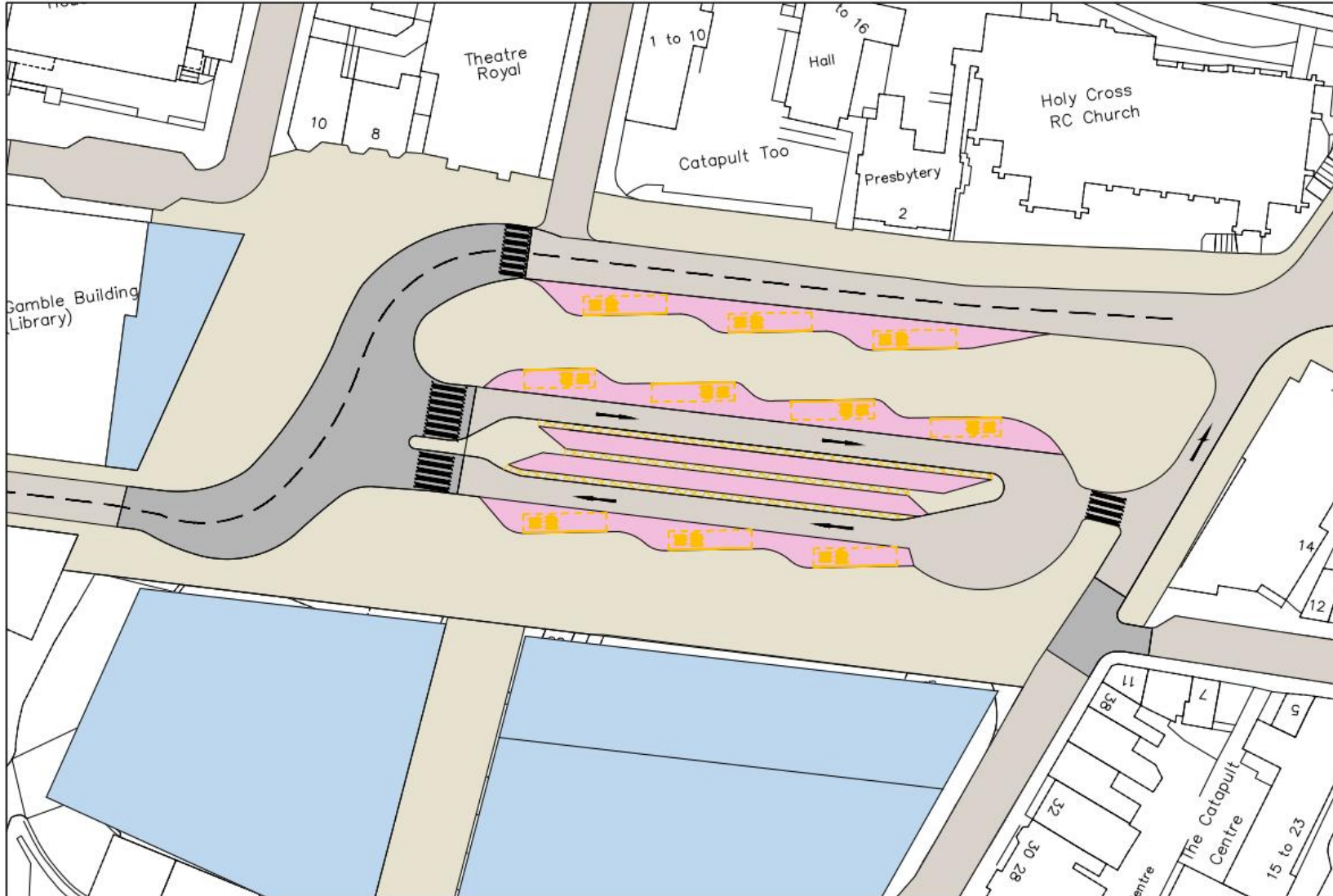

47

# Presented RIBA Report Layout

48





# Indicative Option 7P

49

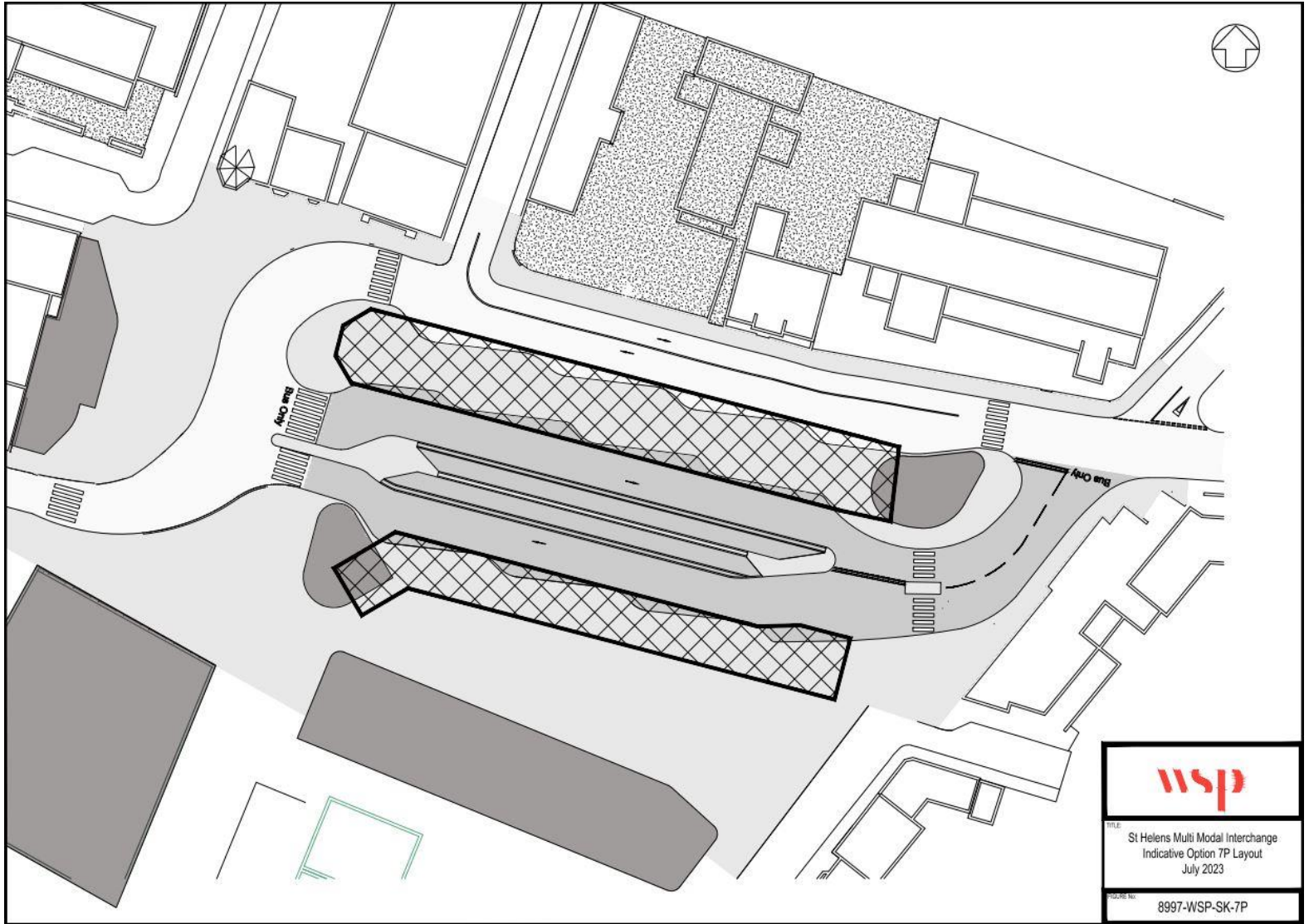

TITLE: St Helens Multi Modal Interchange Indicative Option 7P Layout July 2023	
SOURCE NO: 8997-WSP-SK-7P	

# Indicative Internal Building Accommodation



50